

PHIL ABRAHART

POWERED BY
exp UK

Sycamore road, Strood, Rochester ME2 2PJ

Guide Price £230,000

3 1 1



This Property is offered for sale through the Modern Method of Auction which is operated by iamsold Limited. VIEWINGS SUNDAY 2ND FEBRUARY MESSAGE ME TO BOOK Discover your dream home right here, a 3-bedroom mid-terrace property. This home is perfect for families, first-time buyers, or anyone looking for a commuter-friendly location. Includes Solar panels reduce energy bills and provide a sustainable living option. Open-plan ground floor offers a seamless flow between the living and dining spaces. Modern kitchen with built-in appliances. Stylish shower room with contemporary design and high-quality finishes, garden with a summerhouse, ideal as a home office/gym. ****Please note that the house is built from concrete and steel known as NSC(non standard construction) as some lenders will not lend on a house like this but many others do and in fact there is a mortgage presently on the house. Please Quote PA1009 when calling in**

07778 703 438
phil.abrahart@exp.uk.com
philabrahart.exp.uk.com



Phil Abrahart is an approved agent of eXp World UK Limited, trading as eXp UK, registered at 5 Churchill Place, 10th Floor, London, United Kingdom, E14 5HU. Company number 12016573. VAT no 327 4120 29. If you have instructed another agent to sell your house and instruct eXp World Ltd to sell your property at the same time, then you could be liable to pay both agents. It is recommended that you check the contract you have with your current agent.

PHIL ABRAHART



- For Sale by Modern Auction – T & C's apply
- Buyers fees apply
- 3 bedroom mid-terrace house concrete and steel constructed(NSC)
- Commuters can easily get onto the m2 London or cost bound it's only minutes in the car away
- Energy saving solar panels included
- Subject to Reserve Price
- The Modern Method of Auction
- Modern kitchen includes a dishwasher, oven, hob and microwave built-in
- Park two cars off road right out the front
- Please Quote PA1009 when calling in to enquire

37 Sycamore rd, Strood, Rochester ME2 2PJ

Approximate Gross Internal Floor Area = 99.2 sq m / 1068 sq ft

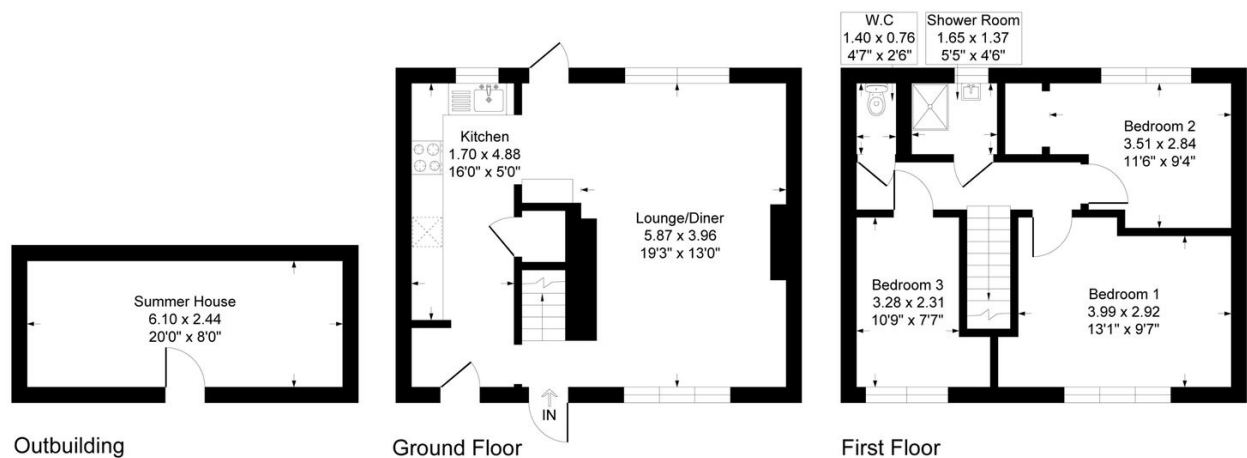

Illustration for identification purposes only, measurements are approximate, not to scale.