



**ADAM  
HALLIWELL**

POWERED BY  
**exp** UK



# Fossebridge Place, Cheltenham, GL52

£300,000

3 2 1





- Semi detached home
- Three bedrooms
- Master with en-suite
- Downstairs Cloakroom
- Two car parking to side
- 32' x 28' Rear garden
- Kitchen/diner to rear
- Entrance hall
- End of the close
- Near fields



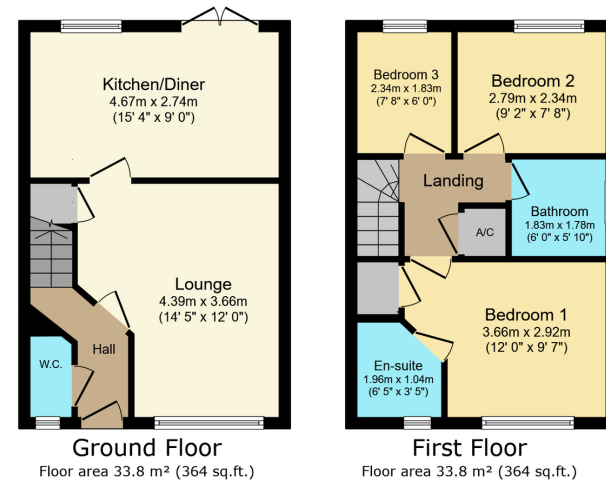

TOTAL: 67.6 m<sup>2</sup> (728 sq.ft.)

This floor plan is for illustrative purposes only. It is not drawn to scale. Any measurements, floor areas (including any total floor area), openings and orientations are approximate. No details are guaranteed, they cannot be relied upon for any purpose and do not form any part of any agreement. No liability is taken for any error, omission or misstatement. A party must rely upon its own inspection(s). Powered by www.Propertybox.io

This charming, 2021 built semi-detached house, located at the end of a private cul-de-sac near fields, offers a peaceful setting with a south-facing garden, three bedrooms, two bathrooms, a kitchen/diner, and a living room, alongside unique features like a two-car drive, a downstairs cloakroom/WC, and an EPC rating of B, making it an ideal choice for first-time buyers, investors, and families.

Score	Energy rating	Current	Potential
92+	A		95 A
81-91	B	82 B	
69-80	C		
55-68	D		
39-54	E		
21-38	F		
1-20	G		

Call us on

01242 906 586 | 07861 238 913

adamhalliwell@exp.uk.com

Orlando, Old Reddings Road, The Reddings, Cheltenham, GL51 6SA

adam.halliwell.exp.uk.com

Agents Note: Whilst every care has been taken to prepare these particulars, they are for guidance purposes only. All measurements are approximate and are for general guidance purposes only and whilst every care has been taken to ensure their accuracy, they should not be relied upon and potential buyers are advised to recheck the measurements.