



Jodami Crescent, Pittville, Cheltenham, GL50

£375,000

🛏️ 2 🚿 2 🚪 1



- Two Bedrooms
- Built by Bloor Homes
- Downstairs W/C
- En-Suite shower room in main bedroom
- Garage with utility area
- Link-Detached house
- Modern Kitchen/Dining Room
- Freshly redecorated for a modern look and homely feel
- Off-Road Parking
- Double Glazing and Gas Central Heating



A two-bedroom link-detached home by Bloor Homes, featuring a modern kitchen, spacious living room, landscaped garden, built-in storage, en-suite to master, downstairs WC, off-road parking, double glazing, and gas central heating.



Approximate Gross Internal Area 796 sq ft - 74 sq m
 Ground Floor Area 470 sq ft - 44 sq m
 First Floor Area 326 sq ft - 30 sq m

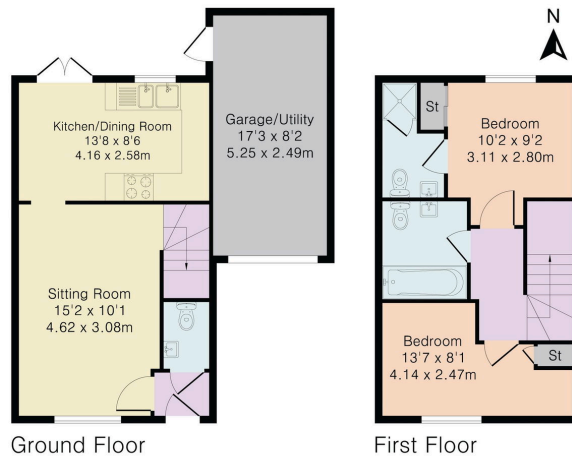

Energy Efficiency Rating		
	Current	Potential
<i>Very energy efficient - lower running costs</i>		
(92 plus) A		96
(81-91) B	82	
(69-80) C		
(55-68) D		
(39-54) E		
(21-38) F		
(1-20) G		
<i>Not energy efficient - higher running costs</i>		
England & Wales	EU Directive 2002/91/EC	



Elliot Oliver Sales
 101 Promenade, Cheltenham GL50 1NW
 01242 321091
 www.elliottoliver.co.uk

