



# Princes Road, Cheltenham, GL50

Offers Over £400,000

🛏️ 2 🪑 2 🛋️ 2



- Charming period mid-terrace property
- Galley-style kitchen
- Two bedrooms
- Modern family bathroom
- Tivoli location
- Front lounge with feature fireplace
- Dining room with direct access to kitchen
- Loft space
- Low maintenance rear courtyard garden
- No onward chain



This delightful period mid-terrace home, located in the ever-popular Tivoli area, is perfect for those seeking a property full of character, with modern comforts and no onward chain.

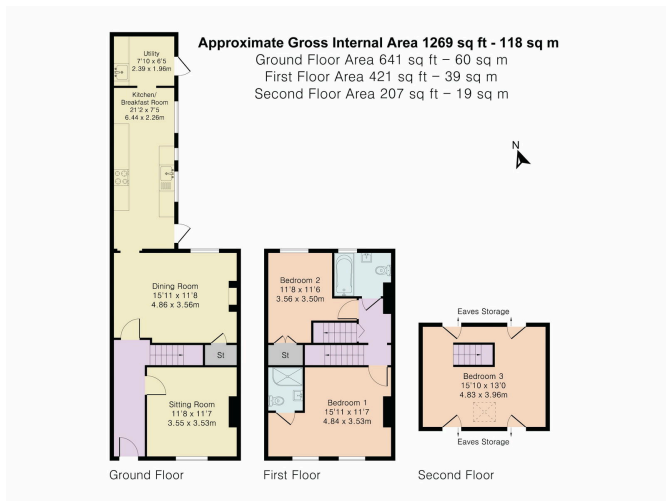

PINK PLAN

Although Pink Plan Ltd ensures the highest level of accuracy, measurements of doors, windows and rooms are approximate and no responsibility is taken for error, omission or misstatement. These plans are for representation purposes only as defined by RICS code of measuring practice. No guarantee is given on total square footage of the property within this plan. The figure shown is for initial guidance only and should not be relied on as a basis of valuation.



Energy Efficiency Rating		
	Current	Potential
Very energy efficient - lower running costs		
(92 plus) <b>A</b>		
(81-91) <b>B</b>		83
(69-80) <b>C</b>		
(55-68) <b>D</b>	59	
(39-54) <b>E</b>		
(21-38) <b>F</b>		
(1-20) <b>G</b>		
Not energy efficient - higher running costs		
<b>England &amp; Wales</b>	EU Directive 2002/91/EC	



Elliot Oliver Sales  
 101 Promenade, Cheltenham GL50 1NW  
 01242 321091  
 www.elliottoliver.co.uk

