

Portland Gardens, Pittville, Cheltenham, GL52

£250,000

2 2 1



This beautifully appointed top-floor apartment in the sought-after Pittville area offers a perfect blend of space, style, and convenience. With two well-proportioned double bedrooms, it's ideal for a range of buyers, from first-time homeowners to those looking to downsize.

Key Features

- Two Bedrooms
- No Onward Purchase
- Immaculately Presented
- Gas Central Heating
- Top Floor Apartment
- Pittville Location
- Allocated Gated Parking
- Modern Finish

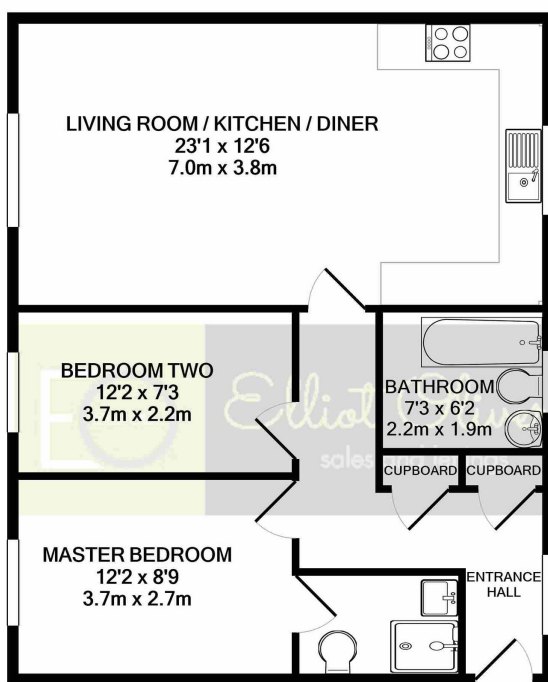

TOTAL APPROX. FLOOR AREA 659 SQ.FT. (61.2 SQ.M.)

Whilst every attempt has been made to ensure the accuracy of the floor plan contained here, measurements of doors, windows, rooms and any other items are approximate and no responsibility is taken for any error, omission, or mis-statement. This plan is for illustrative purposes only and should be used as such by any prospective purchaser. The services, systems and appliances shown have not been tested and no guarantee as to their operability or efficiency can be given
Made with Metropix ©2020