



Leighbrook House, Old Tewkesbury Road, Norton, Gloucester, GL2

£750,000

🛏 4 🚿 3 🛋 3



- A stunning four double bedroom detached family home, built in 2005
- Further rooms to the ground floor include cloakroom and gym
- Kitchen/breakfast room with wealth of units and separate utility room
- On a local bus route
- Sought after location
- Located in this highly desirable village, betwixt of Cheltenham, Tewkesbury and Gloucester
- Separate off road parking for many cars.
- Adaptable accomdation
- Walking distance to a pub



Leighbrook House is a wonderfully spacious four double bedroom detached family home, beautifully presented and located in this highly sought after village betwixt of Cheltenham, Tewkesbury and Gloucester. Offering a high degree of privacy due to the location within the village, the home enjoys a wealth of accommodation across the two floors and is accompanied by a sizeable plot that encases the home and it is because of the above, that the property comes with a high recommendation to view.

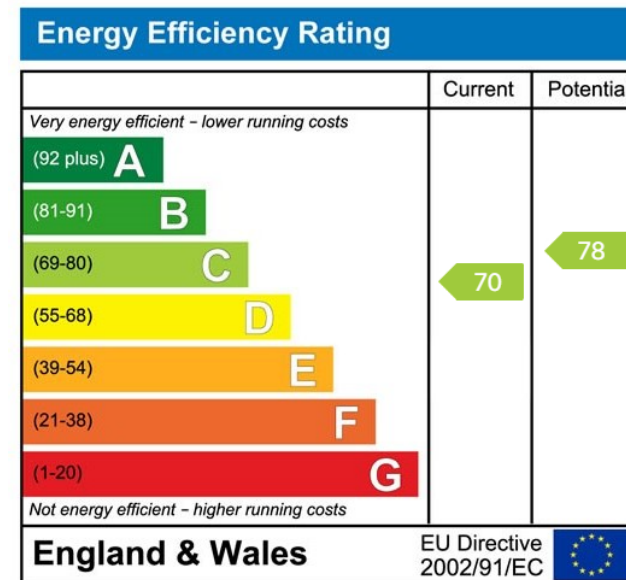
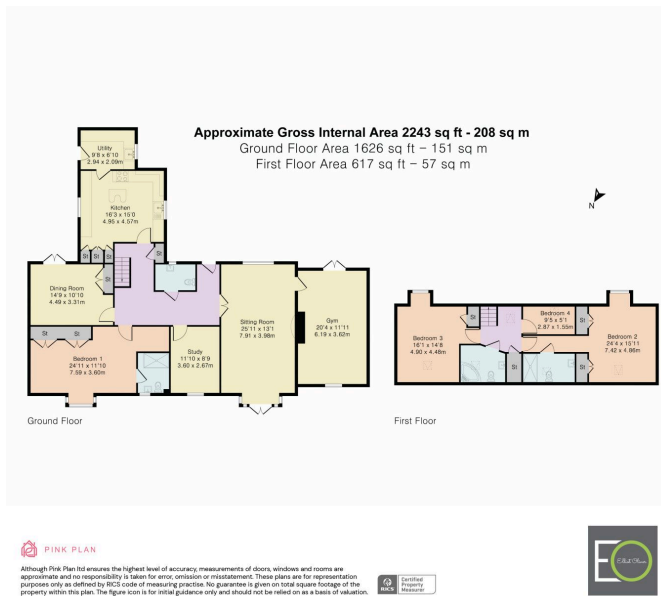

Elliot Oliver Sales
 101 Promenade, Cheltenham GL50 1NW
 01242 321091
 www.elliottoliver.co.uk

