



ALASTAIR SAVILLE
ESTATE AGENTS

Boyer Avenue, Maghull

£150,000

🛏 3 🚿 1 🚗 1



MID TERRACED FAMILY HOME, SAME OWNERSHIP FOR A NUMBER OF YEARS, IN NEED OF SOME UPDATING, THREE BEDROOMS, LIVING ROOM OPENING INTO DINING ROOM, POTENTIAL TO EXTEND TO THE REAR, ENCLOSED GARDENS, OFF ROAD PARKING. OFFERED FOR SALE WITH NO ONWARD CHAIN. VIEWING ESSENTIAL.

This mid terraced family home sits on the edge of the Alt Estate, close to all local amenities and schools. Being in need of some updating, the property has been in the same ownership for a number of years and would now make a superb first time buy or investment. The accommodation comprises entrance hallway, living room opening onto the dining room, kitchen and a sun room that is in need of some repair to the ground floor. To the first floor are three bedrooms and the family bathroom. Externally there are gardens to the front and rear with the rear one having gated side access. There is also a driveway providing off road parking. Viewing is essential to really appreciate everything on offer.



ALASTAIR SAVILLE
ESTATE AGENTS

- Mid Terraced House
- Three Bedrooms
- Enclosed Gardens
- Ideal First Time Buy/ Investment
- EPC Rating- Pending
- In Need Of Some Updating
- Living Room Leading Onto Dining Room
- Off Road Parking
- No Onward Chain
- Council Tax Band-B

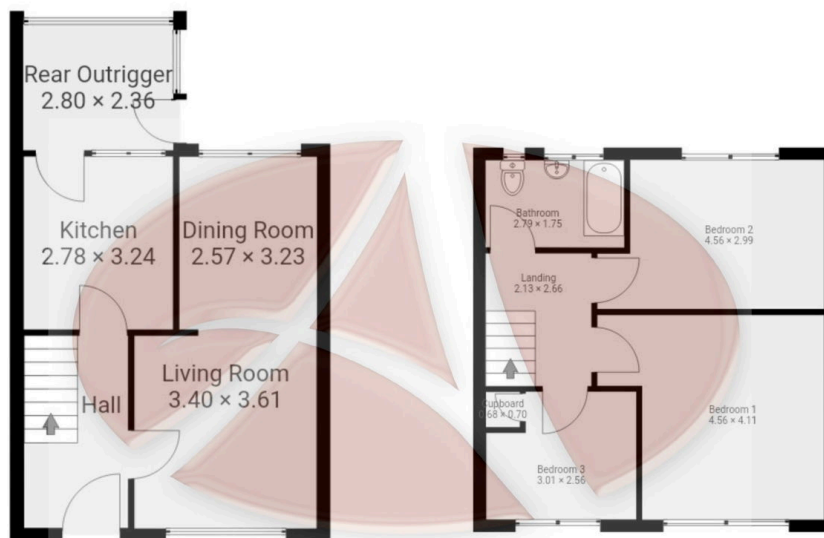

Ground floor area 43.1m²

1st Floor area 42.2m²

64 Boyer Avenue, L31 5NX

Whilst every effort is made to accurately reproduce these floor plans, measurements are approximate, not to scale and for illustrative purposes only

Measurements, floor-areas, openings and orientations are approximate. They should purpose and do not form any part of an agreement. No liability is taken for any error or mis-statement. All parties must rely on their own inspections.