



ALASTAIR SAVILLE
ESTATE AGENTS

Lowry Close, Kirkby

£250,000

3 2 2



- Detached Family Home In Tucked Away Location
- Three Reception Rooms
- Family Bathroom
- Utility Room And Downstairs WC
- EPC Rating- C
- Popular Littledale Estate
- Three Double Bedrooms- One With Ensuite
- Beautifully Presented Throughout
- Driveway And Enclosed Gardens
- Council Tax Band- C



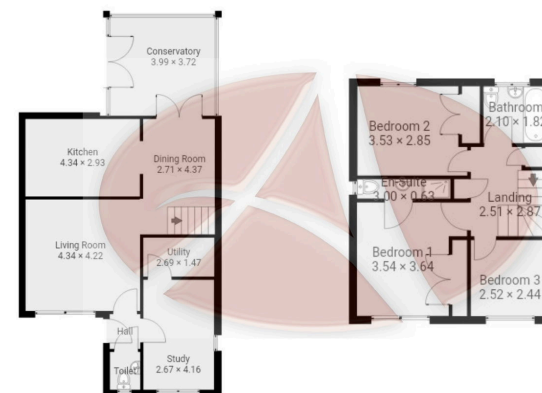

Ground floor area 75.9m²

1st floor area 42.2m²

5 Lowry Close, L33 4HJ

Whilst every effort is made to accurately reproduce these floor plans, measurements are approximate, not to scale and for illustrative purposes only.
Measurements, floor-areas, openings and orientations are approximate. They should
purpose and do not form any part of an agreement. No liability is taken for any error or mis-statement. All parties must rely on their own inspections.

BEAUTIFULLY PRESENTED DETACHED FAMILY HOME, TUCKED AWAY, SOUGHT AFTER LOCATION, LOVELY OUTLOOK OVER A PARK- SAXON GREEN, THREE RECEPTION ROOMS PLUS CONSERVATORY, MODERN KITCHEN, THREE DOUBLE BEDROOMS- ONE WITH ENSUITE, DOWNSTAIRS WC, MODERN FAMILY BATHROOM, LOVELY ENCLOSED PRIVATE REAR GARDEN, VIEWING ESSENTIAL.

Situated on the Littledale Estate in Kirkby, is the tucked away cul de sac of Lowry Close looking onto Saxon Green. This detached house is a credit to the current vendors who have it presented immaculately and any buyer could just move straight in without lifting a finger. Making a superb family home with spacious accommodation, the property warrants an internal viewing as it is quite deceiving on first impressions.

