



ALASTAIR SAVILLE
ESTATE AGENTS

Coppull Road, Liverpool, L31 2LH

£160,000

🛏 1 🚿 1 🛋 2



- Detached Bungalow
- Modern Fitted Kitchen
- Shower Room
- Spacious Bedroom with Fitted Wardrobes
- Sun Room Leading to Court Yard
- Gardens Side and Front Yard
- EPC Pending
- Council Tax Band A



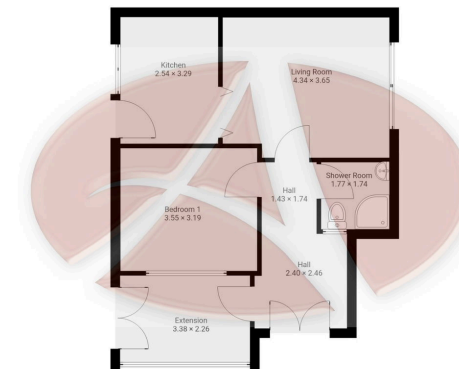

Ground Floor area 54.0m²

53 Coppull Road, L31 2LH

Whilst every effort is made to accurately reproduce these floor plans, measurements are approximate, not to scale and for illustrative purposes only.
Measurements, floor-areas, openings and orientations are approximate. They should
purpose and do not form any part of an agreement. No liability is taken for any error or mis-statement. All parties must rely on their own inspections.

DETACHED BUNGALOW, MODERN FITTED KITCHEN WITH APPLIANCES, SPACIOUS LOUNGE, SHOWER ROOM, BEDROOM WITH FITTED WARDROBES, CONSERVATORY/SUNROOM. SPACIOUS PORCH, COURT YARD AND LOVELY MATURE GARDENS TO SIDE AND REAR.

Alastair Saville are delighted to offer for sale this attractive, one bedroomed, semi detached bungalow situated in a popular residential area of Lydiate being located close to local shops and transport links. The accommodation briefly comprises: Porch, inner Hallway, lounge, modern fitted kitchen, conservatory, shower room, bedroom and gardens to the front and side, to the rear there court yard. The property further benefits from gas central heating and double glazing.

