



ALASTAIR SAVILLE  
ESTATE AGENTS



# Conway Close, Kirkby, L33 1ZW

£120,000

🛏 3 🚿 2 🛋 1





- Spacious Three Bedroom Property
- Modern Kitchen
- Modern Shower Room
- Conservatory
- Downstairs W/C
- Not Over Looked To The Rear
- Spacious Porch and Hallway
- No Chain
- Council Tax Band A
- EPC Rating C



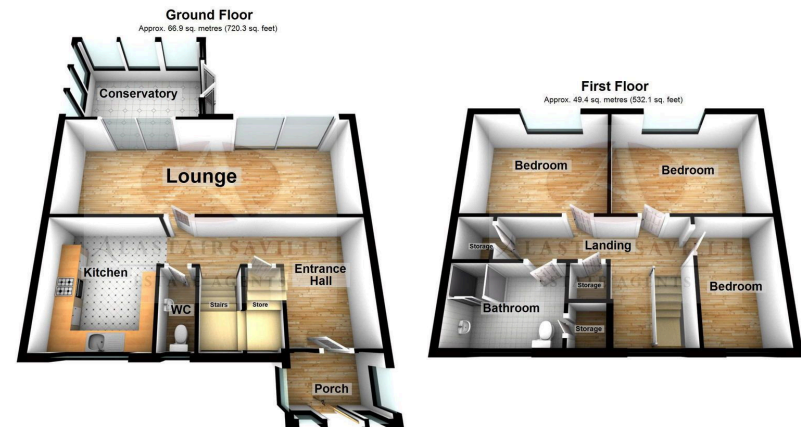

Total area: approx. 116.3 sq. metres (1252.3 sq. feet)  
 AEA (Aughton energy Assessors) provide this Floor Plan as a guide to the overall dimensions of the property. Dimensions are approximate and do not pertain to be absolutely accurate but are provided as a guide.  
 Plan produced using PlanUp.

12 Conway Close, Kirkby

MODERN KITCHEN AND SHOWER ROOM, SPACIOUS LOUNGE/ DINER, CONSERVATORY, THREE GENEROUS SIZE BEDROOMS, Deceptively spacious and well presented, 3 bedroom, semi detached property sold with NO CHAIN.... The property briefly comprises; good size porch with built in storage, spacious entrance hall, downstairs W.C, fitted kitchen, 24 foot lounge with double patio doors, one leading to the rear garden and one into the conservatory. To the first floor is the modern shower room, two built in storage cupboards, two double bedrooms and one single bedroom. With double glazing, gas central heating and front and rear gardens, early viewing is advised!

