

6 Plas Road, Rhy, LL18 4HT

£174,950

🛏️ 2 🚿 1 🚗 1



This delightful detached bungalow boasts of a cosy layout featuring two bedrooms, a good size lounge with picture window to the front, kitchen, and bathroom. Contributing to the overall appeal of the home is it's 'fairytale' like rear garden, being its own little oasis, offering a serene outdoor space for relaxation and enjoyment. Additionally, it includes a garage, providing security with a long driveway providing ample parking. The location of this property is highly desirable, with excellent public transport links, being close to all public amenities and schools for all ages are well catered for.

Key Features

- Delightful detached bungalow
- Serene rear garden
- Well presented
- Garage
- Freehold
- Two bedrooms
- Close to local amenities
- Ample parking
- EPC - D
- Date - 27/06/2024, Price adjusted 30/01/25

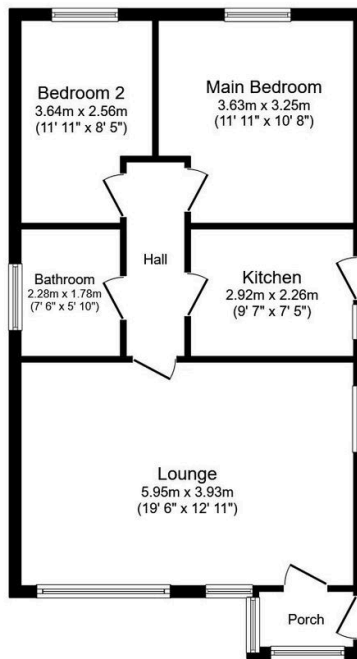

Floor Plan

Floor area 62.0 m² (668 sq.ft.)

TOTAL: 62.0 m² (668 sq.ft.)

This floor plan is for illustrative purposes only. It is not drawn to scale. Any measurements, floor areas (including any total floor area), openings and orientations are approximate. No details are guaranteed, they cannot be relied upon for any purpose and do not form any part of any agreement. No liability is taken for any error, omission or misstatement. A party must rely upon its own inspection(s). Powered by www.Propertybox.io