

## 16 Carlisle Avenue, Rhyl, LL18 3UD

£179,950

🛏️ 2 🚿 1 🚺 1



For sale is this two bedroom detached bungalow, while in need of modernisation, holds an abundance of potential and can be transformed into a contemporary living space with a personal touch. With front porch, lounge, shower room, kitchen leading to a substantial side vestibule with access to the front and rear gardens. One of its unique features is its lovely garden with a quaint summer house and shed. The location of this property is perfect for those who enjoy spending time by the coast. With numerous walking and cycling routes on the seafront and promenade, with the town centre being within a short distance.

## Key Features

- Two bedrooms
- Lovely garden
- Perfect for personalisation
- Off street parking
- EPC - C / Council tax - C
- Detached Bungalow
- Quaint Summerhouse
- Close to seafront and promenade
- Freehold
- 05/11/2024

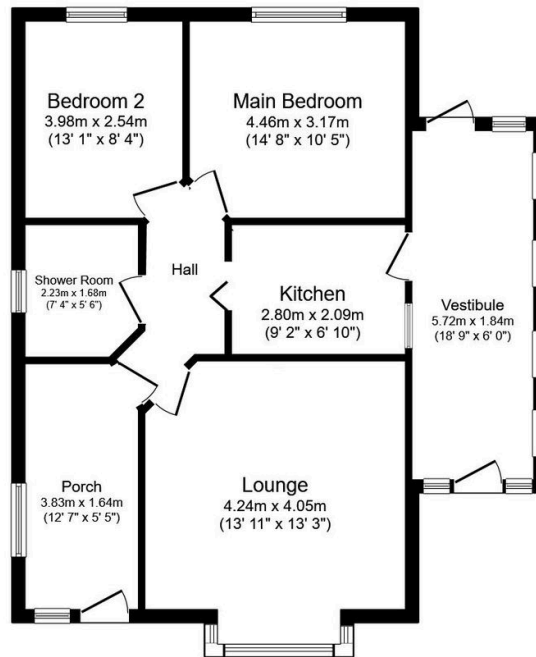

### Floor Plan

Floor area 70.5 m<sup>2</sup> (759 sq.ft.)

TOTAL: 70.5 m<sup>2</sup> (759 sq.ft.)

This floor plan is for illustrative purposes only. It is not drawn to scale. Any measurements, floor areas (including any total floor area), openings and orientations are approximate. No details are guaranteed, they cannot be relied upon for any purpose and do not form any part of any agreement. No liability is taken for any error, omission or misstatement. A party must rely upon its own inspection(s). Powered by [www.Propertybox.io](http://www.Propertybox.io)