

12 Hadley Crescent Rhyl

Offers In Region Of £145,000

🛏 2 🚿 1 🚗 1



We are delighted to offer this traditional double fronted two bedroom detached bungalow for sale in a popular residential area, the town of Rhyl with its shops and public amenities being a short distance away, the beach and promenade are also within easy reach. Having low maintenance brick paviour front garden with good size mature rear garden. It offers scope to enhance with cosmetic improvements required, however it benefits by way of gas central heating, double glazing and off street parking.

Key Features

- Two bedroom detached bungalow
- Good size garden to the rear
- Ideal retirement
- Gas central heating
- EPC - D
- Popular location
- Off road parking
- Cosmetic improvements required
- Freehold
- 14/11/2024

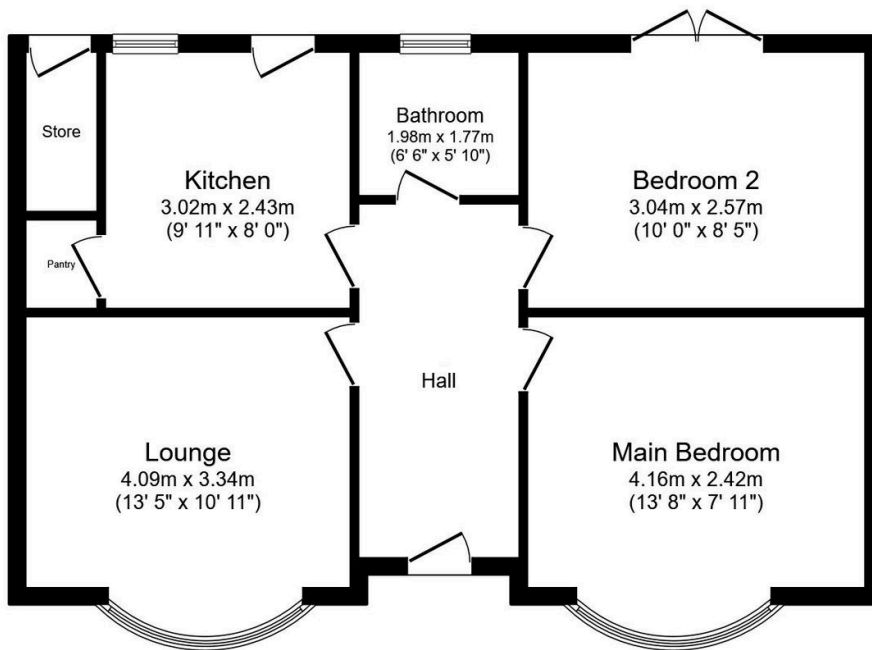

Floor Plan

Floor area 69.7 sq.m. (750 sq.ft.)

TOTAL: 69.7 sq.m. (750 sq.ft.)

This floor plan is for illustrative purposes only. It is not drawn to scale. Any measurements, floor areas (including any total floor area), openings and orientations are approximate. No details are guaranteed, they cannot be relied upon for any purpose and do not form any part of any agreement. No liability is taken for any error, omission or misstatement. A party must rely upon its own inspection(s). Powered by www.Propertybox.io