



Victoria Bolt
estate agents POWERED BY **exp** UK

Lyra Vale, Sherford
Guide Price £365,000

🛏️ 4 🚿 3 🚗 1



- Three/Four bedroom Townhouse, only 12 months old
- Master bedroom with ensuite
- Perfect family home
- Modern kitchen
- Garage and off street parking
- Downstairs WC and family bathroom on the second floor
- Easy to maintain garden with shed
- Close to local amenities
- Located in a popular area



Nestled within the new town of Sherford is this impeccably presented townhouse that epitomizes stylish and convenient modern family living. It boasts four spacious double bedrooms, each offering an abundance of space and comfort. The master suite is a true retreat, featuring its own ensuite bathroom.

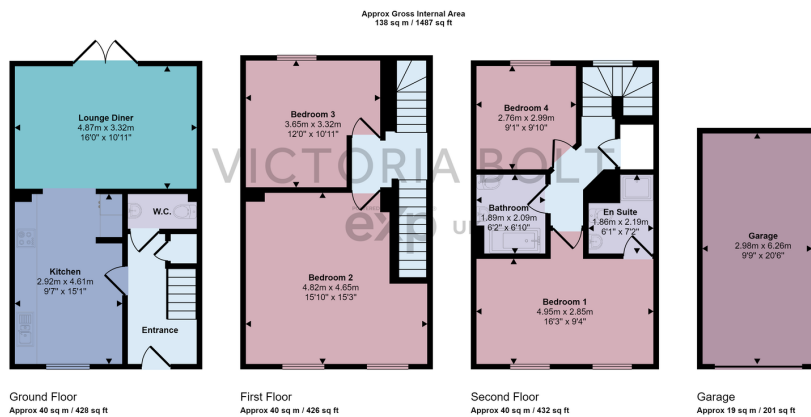

This floorplan is only for illustrative purposes and is not to scale. Measurements of rooms, doors, windows, and any items are approximate and no responsibility is taken for any error, omission or mis-statement. Icons of items such as bathroom suites are representations only and may not look like the real items. Made with Magic Snappy 360.

