

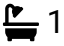

Godshill

£250,000

 3  1  1

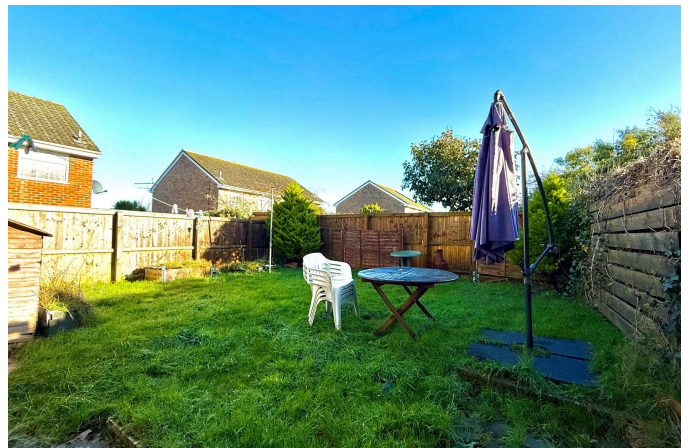

- Semi-detached 3-Bedroom Home
- Spacious Open Plan Living Dining Area
- Traditional Layout with Potential to Modernise
- Front and Rear Gardens
- Driveway
- Garage
- Picturesque Village
- Local Amenities - School, Pub and Restaurants
- Minutes from Newport
- Opportunity to Purchase in an Upcoming Location

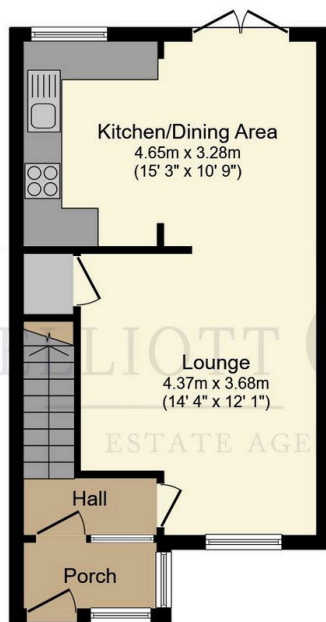

Ground Floor

Floor area 37.6 m² (404 sq.ft.)

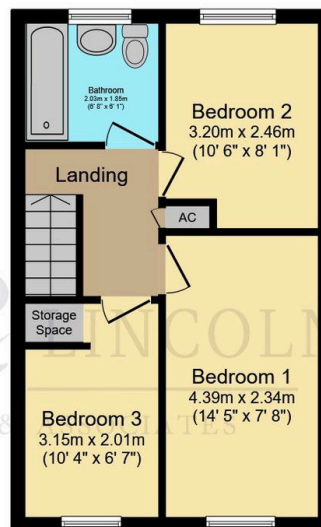

First Floor

Floor area 35.2 m² (378 sq.ft.)

TOTAL: 72.7 m² (783 sq.ft.)

This floor plan is for illustrative purposes only. It is not drawn to scale. Any measurements, floor areas (including any total floor area), openings and orientations are approximate. No details are guaranteed, they cannot be relied upon for any purpose and do not form any part of any agreement. No liability is taken for any error, omission or misstatement. A party must rely upon its own inspection(s). Powered by www.Propertybox.io

A 1970s-built semi-detached home offering a wonderful blend of spacious living and potential for personalisation. Boasting a traditional layout, generous room sizes, and a fantastic location, this property provides a superb opportunity for buyers looking to make a house their own.