



JAMES PYLE & Co.



Tedrose Cottage, 17 Cliff Road, Sherston, Malmesbury, Wiltshire, SN16 0LN

Cotswold stone period cottage
Scope to update and modernise
2 bedrooms

Attic with potential to convert
Spacious living room
Westerly rear garden

Located a short distance from the High Street
No onward chain



01666 840 886
jamespyle.co.uk



The Barn, Swan Barton, Sherston, Wiltshire, SN16 0LJ
James Pyle Ltd trading as James Pyle & Co. Registered in England & Wales No: 08184953

Price Guide: £375,000

Approximately 790 sq.ft excluding attic

‘Situated in the heart of the desirable village of Sherston close to the High Street, this Cotswold stone cottage is deceptive in size and offers fantastic potential to enlarge and modernise the accommodation’



The Property

Tedrose Cottage is a period terraced cottage situated in the heart of Sherston, a short distance from the High Street and many amenities. The property has been within the same family ownership for generations having been extended and well-maintained and today offers great scope to modernise as well as alter the layout to include an attic floor as accommodation (subject to planning).

The cottage is deceptive in size particularly on the ground floor which comprises a front living room with open fireplace, a good size kitchen/breakfast room, rear porch/garden room and a ground floor bathroom. On the first floor there are two good bedrooms. The attic has been partially converted with a dormer window and is accessible by a drop-down ladder.

At the rear there is a pleasant sized garden with a timber workshop/store. On street parking is easily available on Cliff Road.

Situation

The beautiful, ancient and much sought after village of Sherston with its broad High Street and historic stone houses is set in an Area of Outstanding Natural Beauty conveniently located on the edge of the Cotswolds. Sherston has a thriving community and offers many facilities, including a church, popular primary school, doctors surgery, Co-op shop and post office, coffee shops, hairdresser, Indian restaurant, garden centre and the highly regarded 16th century Rattlebone Inn, with its excellent food and friendly atmosphere. The facilities and amenities in Sherston more than adequately provide for everyday need with a whole host of societies and clubs meeting on a regular basis offering entertainment and social events for young and old alike. Schooling locally is second to none, with very good state and independent schools providing transport to and from the village on a daily basis. Close by are the market towns of Malmesbury and Tetbury which are both approximately 5 miles away. Malmesbury is reputed to be the oldest Borough

in the country dating back to the 11th Century. Both towns offer a wider range of shops, services, schooling and leisure facilities. There are main line stations to London-Paddington at Kemble (14 miles) and Chippenham (12 miles) whilst Junctions 17 & 18 of the M4 are both within 15 minutes' drive providing convenient access to Bath, Bristol and Swindon.

Additional Information

The property is Freehold with oil-fired central heating, mains drainage, water and electricity. The property is located within the Cotswold Area of Outstanding Natural Beauty and a conservation area. Superfast broadband is available and there is good mobile phone coverage with some limitations. Information taken from the Ofcom mobile and broadband checker, please see the website for more information. Wiltshire Council Tax Band C.

Directions

From the High Street, turn left opposite the shop

onto Court Street and follow the street. Then turn left onto Cliff Road and locate the property half way down on the right hand side.

Postcode SN16 0LN
What3words: ///traders.expel.putty



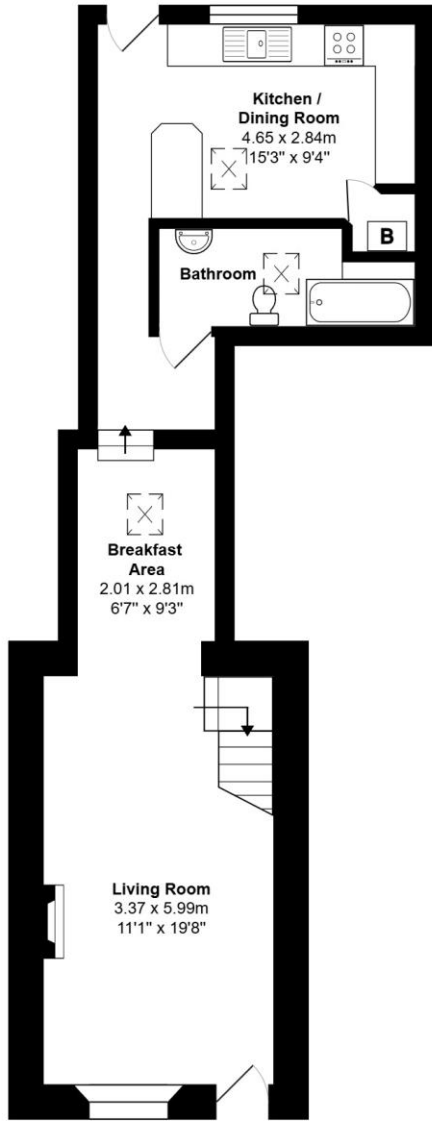

Ground Floor

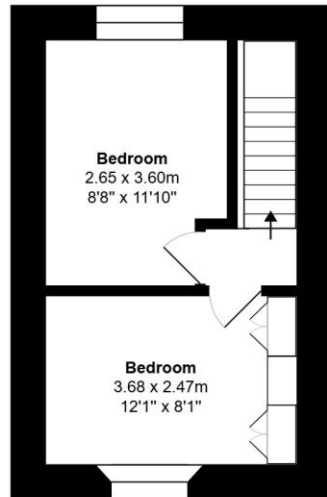

First Floor



Main Area: 73.4 m.sq ... 790 sq.ft. (excluding attic)

Total Area: 88.0 m² ... 948 ft²

All measurements are approximate and for display purposes only

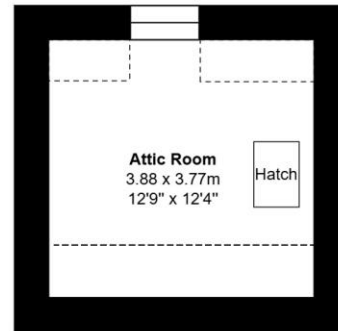

Second Floor



James Pyle Holdings Ltd and any parties they are acting for hereby give notice that these details are for guidance only and cannot guarantee accuracy of any description, dimension, condition or any required permission for occupation and use. It is not company policy to test any services or appliances in properties offered for sale and these should be verified by the purchaser's solicitors. James Pyle Holdings Ltd will not be liable for any loss arising from the use of these details. No responsibility is taken for any errors, omissions or misstatements within these particulars. It should not be assumed that the property has all the necessary planning, building regulation or other consents. These particulars do not form any part of any offer or contract and must not be relied upon as statements or representations of fact. James Pyle & Co is a trading name of James Pyle Holdings Ltd, registered in England & Wales. Registered number 10927906

COTSWOLD & COUNTY (HEAD OFFICE)

The Barn, Swan Barton, Sherston SN16 0LJ

01666 840 886 or 01452 812 054

LONDON (ASSOCIATE OFFICE)

121 Park Lane, Mayfair W1k 7AG

0207 0791 577