



46

enfields

Enfields Hythe
3 Kings Parade
Hythe, Southampton
Hampshire, SO45 6AN
023 8084 0210
sales-hythe@enfields.co.uk

Litchfield Road, Southampton, SO18 2BB

Guide Price £325,000

3 1 2



- No Forward Chain
- Detached Family Home
- First Time To Market Since Built In 1964
- Spacious Living/Dining Room
- Driveway And Carport
- Private Rear Garden
- Potential To Extend
- Sought After Location
- Some Modernisation Required
- Gas Central Heating And Double Glazing Throughout



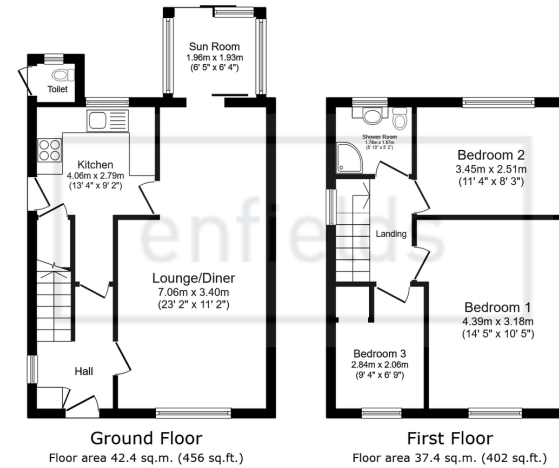

Total floor area: 79.7 sq.m. (858 sq.ft.)

This floor plan is for illustrative purposes only. It is not drawn to scale. Any measurements, floor areas (including any total floor area), openings and orientations are approximate. No details are guaranteed, they cannot be relied upon for any purpose and do not form any part of any agreement. No liability is taken for any error, omission or misstatement. A party must rely upon its own inspection(s). Powered by www.Propertybox.io



NO FORWARD CHAIN

Enfields are pleased to offer to the market for the first time since built in 1964 this three bedroom detached family home situated in the ever popular Bitterne Park and available for sale with no forward chain.

www.enfields-southampton.co.uk



It is Enfields policy to respect any sole agency currently in force and we would not be able to commence marketing until this has expired or been terminated. If you fail to terminate any previous agreement you could be liable for two sets of fees. Enfields Hythe is a trading name of YTF LTD Registered office: 345 Shirley Road, Southampton, Hampshire, England, SO15 3JD. Company Registration No: 10459987. VAT Registration No: 281 2975 81.

Enfields Lettings - Embley Management LTD T/A Enfields. Registered Address: 345 Shirley Road, Southampton, Hampshire, England, SO15 3JD. Company Registration No: 14847604. VAT Registration No: 439 8546 45.