



enfields

Enfields Home
enfields.co.uk

Nightingale Grove, Southampton, SO15 3HQ

£115,000

1 1 1



- No Forward Chain
- First Floor Flat
- Communal Gardens
- One Double Bedroom
- Long Lease Length
- Ideal First Time Buy Or Investment



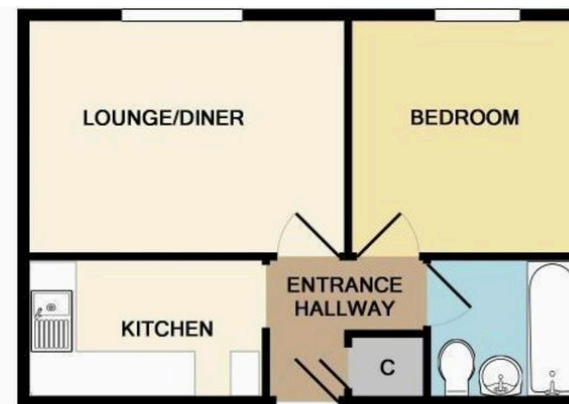

TOTAL APPROX. FLOOR AREA 353 SQ.FT. (32.7 SQ.M.)

Whilst every attempt has been made to ensure the accuracy of the floor plan contained here, measurements of doors, windows, rooms and any other items are approximate and no responsibility is taken for any error, omission, or mis-statement. This plan is for illustrative purposes only and should be used as such by any prospective purchaser. The services, systems and appliances shown have not been tested and no guarantee as to their operability or efficiency can be given
Made with Metropix ©2016

Well-presented one bed first floor flat in Shirley, close to shops and within walking distance of Central Station. Features include lounge/diner, double glazing, communal garden and parking. No forward chain.

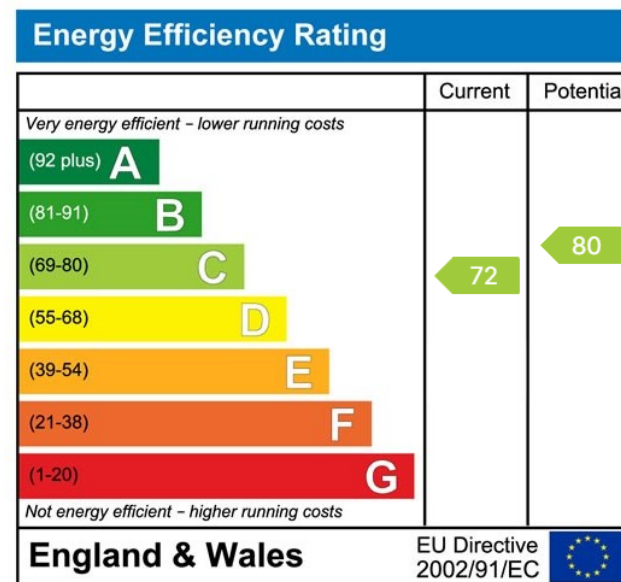

www.enfields-southampton.co.uk



It is Enfields policy to respect any sole agency currently in force and we would not be able to commence marketing until this has expired or been terminated. If you fail to terminate any previous agreement you could be liable for two sets of fees. Enfields Hythe is a trading name of YTF LTD Registered office: 345 Shirley Road, Southampton, Hampshire, England, SO15 3JD. Company Registration No: 10459987. VAT Registration No: 281 2975 81.

Enfields Lettings - Embley Management LTD T/A Enfields. Registered Address: 345 Shirley Road, Southampton, Hampshire, England, SO15 3JD. Company Registration No: 14847604. VAT Registration No: 439 8546 45.