



enfields

Enfields Hythe
3 Marsh Parade
Hythe, Southampton
Hampshire, SO45 6AN
023 8084 9210
sales-hythe@enfields.co.uk

Oakley Road, Southampton, SO16 4LH

Guide Price £300,000

3 1 2



- Three well-proportioned bedrooms
- Modern fitted kitchen with ample storage
- Characterful original fireplace
- Freshly decorated in neutral tones throughout
- Potential to extend (subject to planning permission)
- Two spacious reception rooms
- Stylish contemporary shower room
- High ceilings and large windows providing excellent natural light
- Well-maintained enclosed rear garden
- Convenient location close to schools, shops, parks, motorway links and Southampton General Hospital



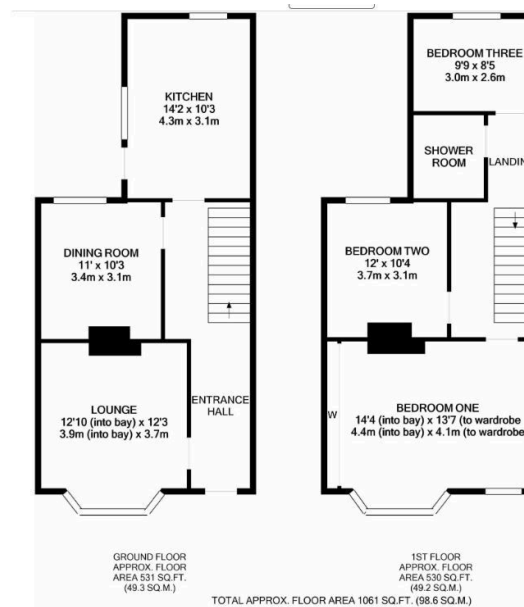

A spacious and well-presented three-bedroom terraced home located on the popular Oakley Road in Southampton, offering bright living spaces and a private enclosed garden. With two reception rooms, a modern kitchen and stylish shower room, the property is ready to move straight into while still offering potential to extend (subject to permissions).

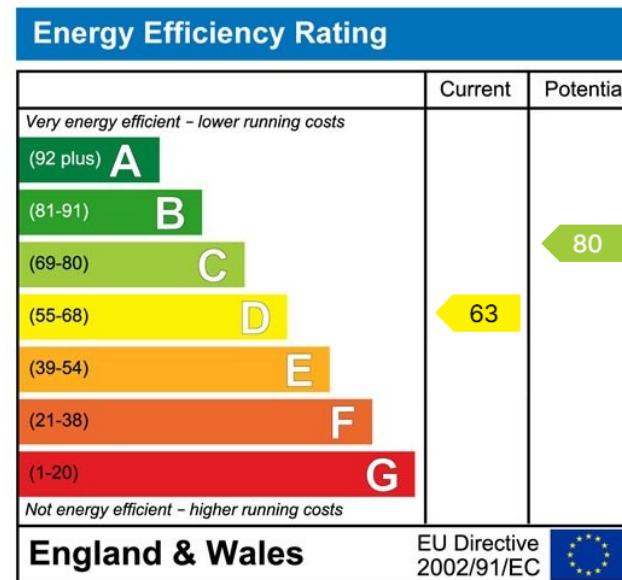

www.enfields-southampton.co.uk



It is Enfields policy to respect any sole agency currently in force and we would not be able to commence marketing until this has expired or been terminated. If you fail to terminate any previous agreement you could be liable for two sets of fees. Enfields Hythe is a trading name of YTF LTD Registered office: 345 Shirley Road, Southampton, Hampshire, England, SO15 3JD. Company Registration No: 10459987. VAT Registration No: 281 2975 81.

Enfields Lettings - Embley Management LTD T/A Enfields. Registered Address: 345 Shirley Road, Southampton, Hampshire, England, SO15 3JD. Company Registration No: 14847604. VAT Registration No: 439 8546 45.