



Enfields Eastleigh
1E Leigh Road,
Eastleigh, Southampton,
Hampshire, SO50 9FG
T 023 8061 3646
E sales-eastleigh@enfields.co.uk

Bracken Crescent, Bishopstoke, Eastleigh, SO50 8ND

Offers Over £170,000

🛏️ 2 🚿 1 🛋️ 1



This purpose built development is located near to local amenities, schools, bus routes and good transport links to the surrounding areas.

Bishopstoke is a village located between Eastleigh and Fair Oak and situated on the eastern bank of the River Itchen. The ancient woodland of Stoke Park Woods is a short walk away and is ideal for a peaceful walk or adventurous bike ride.

The accommodation on offer comprises of a spacious living room with door access leading to a small terrace area and the communal gardens, modern fitted kitchen with space and plumbing for household appliances, family bathroom with white suite and two double bedrooms with bedroom two benefitting from fitted wardrobes and storage cupboard. Additional benefits include double glazing and heating throughout.

Externally there is an allocated parking space and access to the well tended communal gardens.

The School catchment areas are Stoke Park Infant School, Stoke Park Junior School and Wyvern College.

The Service Charge for the property is approximately £1,300.00 per annum.

The Local Authority is Eastleigh Borough Council. Council Tax Band: A.



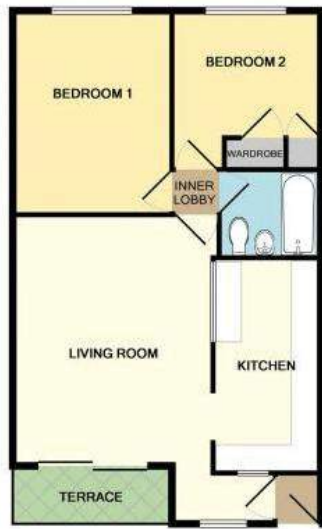

This Floor Plan is for guidance only and is NOT to SCALE
Made with Metropix ©2015

- Ground Floor Apartment
- Spacious Living Room
- Bathroom
- Allocated Parking
- Two Double Bedrooms
- Modern Fitted Kitchen
- Share of Freehold
- Viewing Highly Recommended

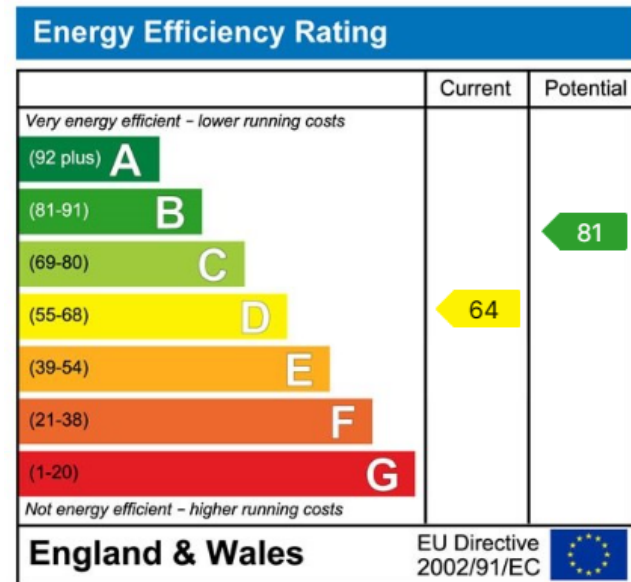

www.enfields-southampton.co.uk



It is Enfields policy to respect any sole agency currently in force and we would not be able to commence marketing until this has expired or been terminated. If you fail to terminate any previous agreement you could be liable for two sets of fees. Enfields Eastleigh is a trading name of YTF LTD Registered office: 345 Shirley Road, Southampton, Hampshire, England, SO15 3JD. Company Registration No: 10459987. VAT Registration No: 281 2975 81.

Enfields Lettings - Embley Management LTD T/A Enfields. Registered Address: 345 Shirley Road, Southampton, Hampshire, England, SO15 3JD. Company Registration No: 14847604. VAT Registration No: 439 8546 45.

