



Enfields Hythe
3 Marsh Parade,
Hythe, Southampton,
Hampshire, SO45 6AN
T 023 8084 9210
E sales-hythe@enfields.co.uk

Station Road, Netley Abbey, Southampton, SO31 5DU

£294,000

3 1 2



This character home comprises of two reception rooms, fitted kitchen, small utility area and W.C to the ground floor with three double bedrooms and family bathroom to the first floor. Additional benefits include double glazing and gas central heating throughout.

The next door property with two commercial units and the leasehold of the above flat can be bought additionally for £150,000.

Externally there is a good sized enclosed garden and on street parking to the front of the home.

The ancient village of Netley Abbey is situated between the City of Southampton and the historic village of Hamble. The village boasts many local amenities and shops. There is also the Royal Victoria Country Park, formerly the site of The Royal Victoria Hospital and now 220 acres of waterside parkland and woodland. Transport links include a local station with connections to Southampton and Portsmouth, road access to M27, M3 and Southampton International Airport.

The Local Authority is Eastleigh Borough Council. Council Tax Band D.



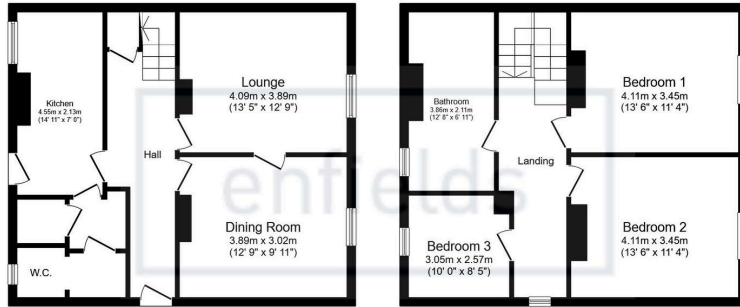

Ground Floor
Floor area 56.8 m² (611 sq.ft.)

First Floor
Floor area 56.8 m² (611 sq.ft.)

TOTAL: 113.5 m² (1,222 sq.ft.)

This floor plan is for illustrative purposes only. It is not drawn to scale. Any measurements, floor area (including any total floor area), openings and orientations are approximate. No details are guaranteed, they cannot be relied upon for any purpose and do not form any part of any agreement. No liability is taken for any error, omission or misstatement. A party must rely upon its own inspection(s). Powered by www.Propertybox.io



- Three Bedroom Cottage
- Three Double Bedrooms
- Semi Detached
- Two Reception Rooms
- Character Property

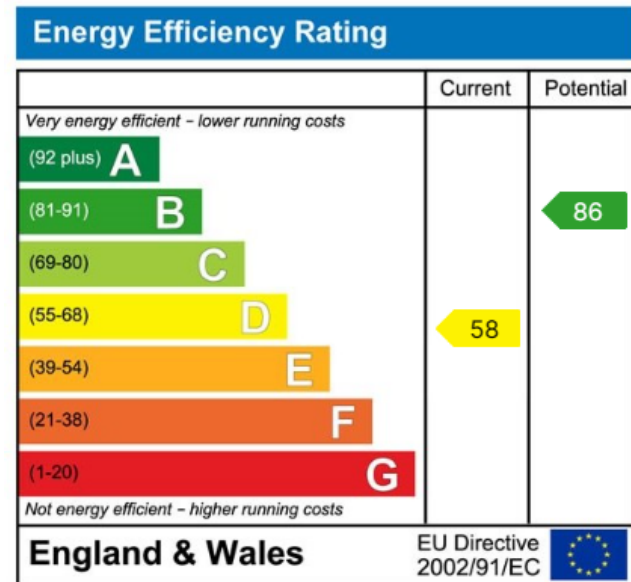

www.enfields-southampton.co.uk



It is Enfields policy to respect any sole agency currently in force and we would not be able to commence marketing until this has expired or been terminated. If you fail to terminate any previous agreement you could be liable for two sets of fees. Enfields Hythe is a trading name of YTF LTD Registered office: 345 Shirley Road, Southampton, Hampshire, England, SO15 3JD. Company Registration No: 10459987. VAT Registration No: 281 2975 81.

Enfields Lettings - Embley Management LTD T/A Enfields. Registered Address: 345 Shirley Road, Southampton, Hampshire, England, SO15 3JD. Company Registration No: 14847604. VAT Registration No: 439 8546 45.

