



**Enfields Eastleigh**  
1E Leigh Road,  
Eastleigh, Southampton,  
Hampshire, SO50 9FG  
T 023 8061 3646  
E [sales-eastleigh@enfields.co.uk](mailto:sales-eastleigh@enfields.co.uk)



Drum Road, Eastleigh, SO50 5ST

Offers Over £170,000

🛏️ 2 🚿 1 🚽 1





**GUIDE PRICE BETWEEN £170,000 - £180,000**

**\*\*\* NO FORWARD CHAIN \*\*\***

This spacious top floor (second floor) two double bedroom apartment offering spacious living accommodation throughout. The property comprises of open planned living and kitchen area with a Juliet balcony, two double bedrooms including master bedroom with en-suite shower room, a separate bathroom and two storage cupboards. Further benefits include an allocated parking space plus visitor parking and a remaining lease of approximately 132 years. Viewing is highly recommended. Ideal for First Time Buyers or Investors.

Annual Service Charge: £2063.78

Annual Ground Rent: £200.00

Lease Remaining: 132 Years

EPC Rating: C



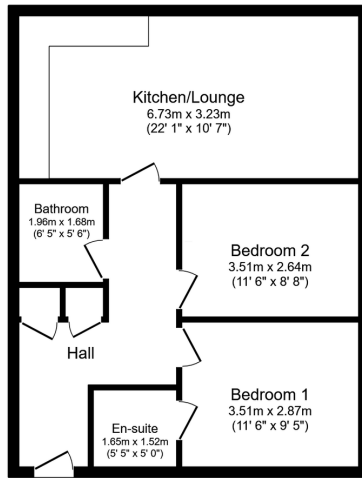

TOTAL: 60.2 m<sup>2</sup> (647 sq.ft.)

This floor plan is for illustrative purposes only. It is not drawn to scale. Any measurements, floor areas (including any total floor area), openings and orientations are approximate. No details are guaranteed, they cannot be relied upon for any purpose and do not form any part of any agreement. No liability is taken for any error, omission or misstatement. A party must rely upon its own inspection(s). Powered by www.Propertybox.ie

- No Forward Chain
- En-Suite To Master Bedroom
- Visitor Parking Available
- Open Planned Living/Kitchen Area
- Walking Distance To Town Center
- Two Double Bedrooms
- Allocated Parking Space
- Top Floor (Second Floor)
- Juliet Balcony
- 132 Year Lease Remaining

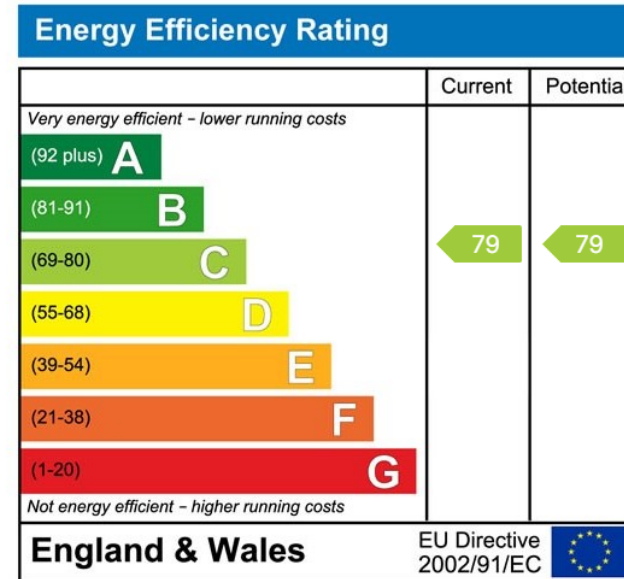
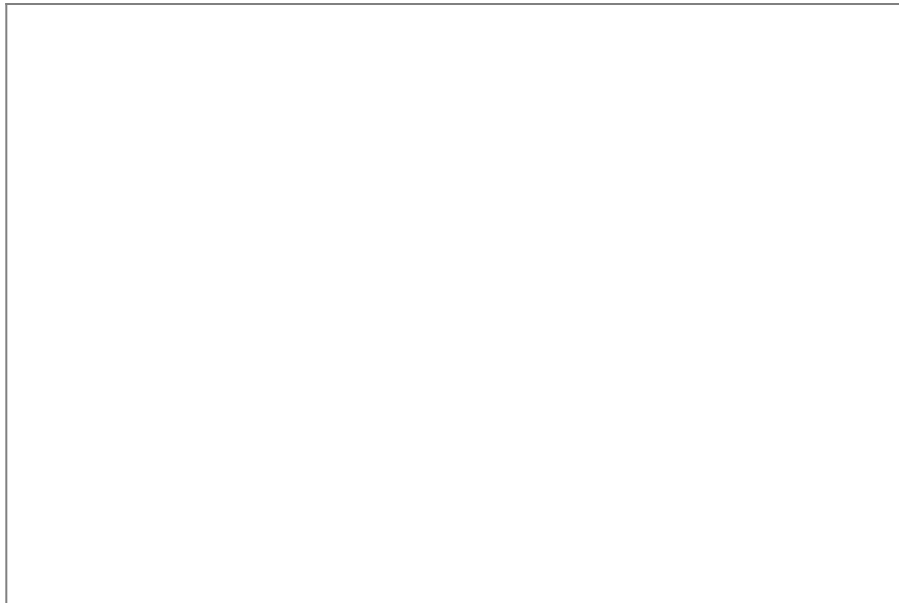

[www.enfields-southampton.co.uk](http://www.enfields-southampton.co.uk)



It is Enfields policy to respect any sole agency currently in force and we would not be able to commence marketing until this has expired or been terminated. If you fail to terminate any previous agreement you could be liable for two sets of fees. Enfields Eastleigh is a trading name of YTF LTD Registered office: 345 Shirley Road, Southampton, Hampshire, England, SO15 3JD. Company Registration No: 10459987. VAT Registration No: 281 2975 81.

Enfields Lettings - Embley Management LTD T/A Enfields. Registered Address: 345 Shirley Road, Southampton, Hampshire, England, SO15 3JD. Company Registration No: 14847604. VAT Registration No: 439 8546 45.

