



enfields

Enfields Hythe
3 Marsh Parade,
Hythe, Southampton,
Hampshire, SO45 6AN
T 023 8084 9210
E sales-hythe@enfields.co.uk

3 Manor Road, Holbury

£299,950

3 1 1



- Move straight in
- Three bedroom end terrace house
- Garage
- Newley decorated throughout
- Large double drive
- Close to shops
- Close to schools
- Fenced in rear garden
- Lean to conservatory
- Call to book a viewing today



This well-maintained three-bedroom end-terrace house offers an excellent opportunity for first-time buyers, downsizers, or those seeking a property with low-maintenance living. The home benefits from a spacious driveway for at least two cars, a detached garage with side access, and a sunny, low-maintenance rear garden featuring artificial lawn and a patio area. Inside, you'll find a bright, refitted kitchen and bathroom, providing modern finishes throughout. The property is situated in a quiet residential area, close to The New Forest National Park, making it ideal for those who enjoy outdoor activities while being within easy reach of local amenities.

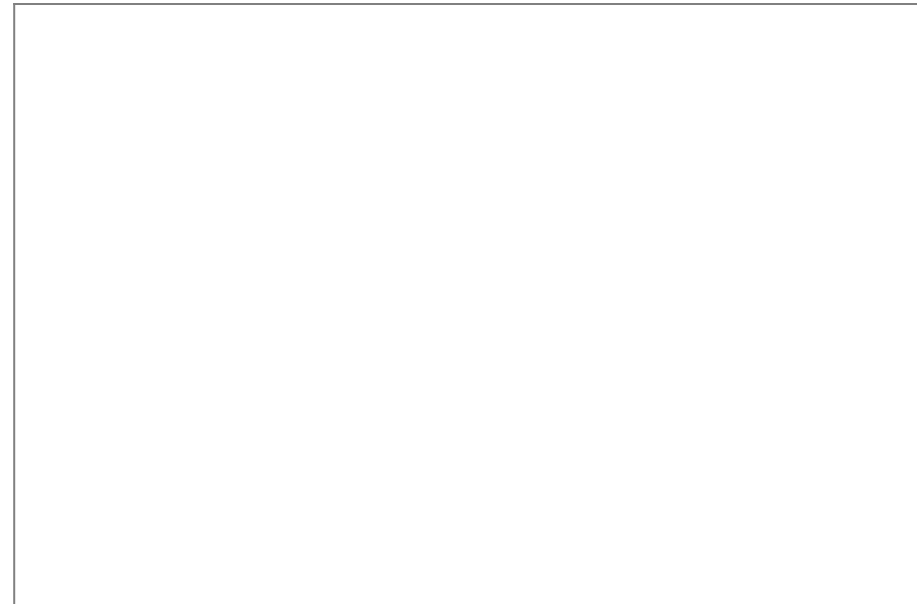
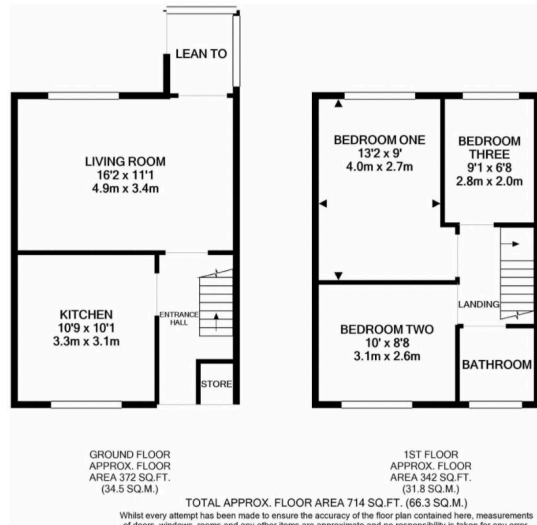

www.enfields-southampton.co.uk



It is Enfields policy to respect any sole agency currently in force and we would not be able to commence marketing until this has expired or been terminated. If you fail to terminate any previous agreement you could be liable for two sets of fees. Enfields Hythe is a trading name of YTF LTD Registered office: 345 Shirley Road, Southampton, Hampshire, England, SO15 3JD. Company Registration No: 10459987. VAT Registration No: 281 2975 81.

Enfields Lettings - Embley Management LTD T/A Enfields. Registered Address: 345 Shirley Road, Southampton, Hampshire, England, SO15 3JD. Company Registration No: 14847604. VAT Registration No: 439 8546 45.