





MILLINGTON TUNNICLIFF

www.millingtontunncliff.co.uk

Lydford Close, Ivybridge, PL21 0YW

£450,000

 4  2  2



An extended 4 bedroom brick built detached house set at the end of this popular cul de sac on a level site convenient for Ivybridge centre. The house offers an entrance porch, hallway, cloakroom, living room, conservatory, dining room, kitchen/breakfast room and utility on the ground floor, together with the 4 bedrooms, en suite shower and family bathroom on the upper floor. The house is Upvc double glazed and gas centrally heated. Externally there is a level garden and a double width driveway leading to the double garage. EPC C 69.

01752 896020 | info@millingtontunncliff.co.uk | 19 Fore Street, Ivybridge, Devon, PL21 9AB



Key Features

- Extended 4 Bedroom Detached House
- Spacious Kitchen/Breakfast Room
- Utility Room
- Sun Room With Warm Roof
- Double Garage
- En Suite Shower/WC
- Cloakroom
- Upvc Double Glazing
- Gas Central Heating
- Level Gardens

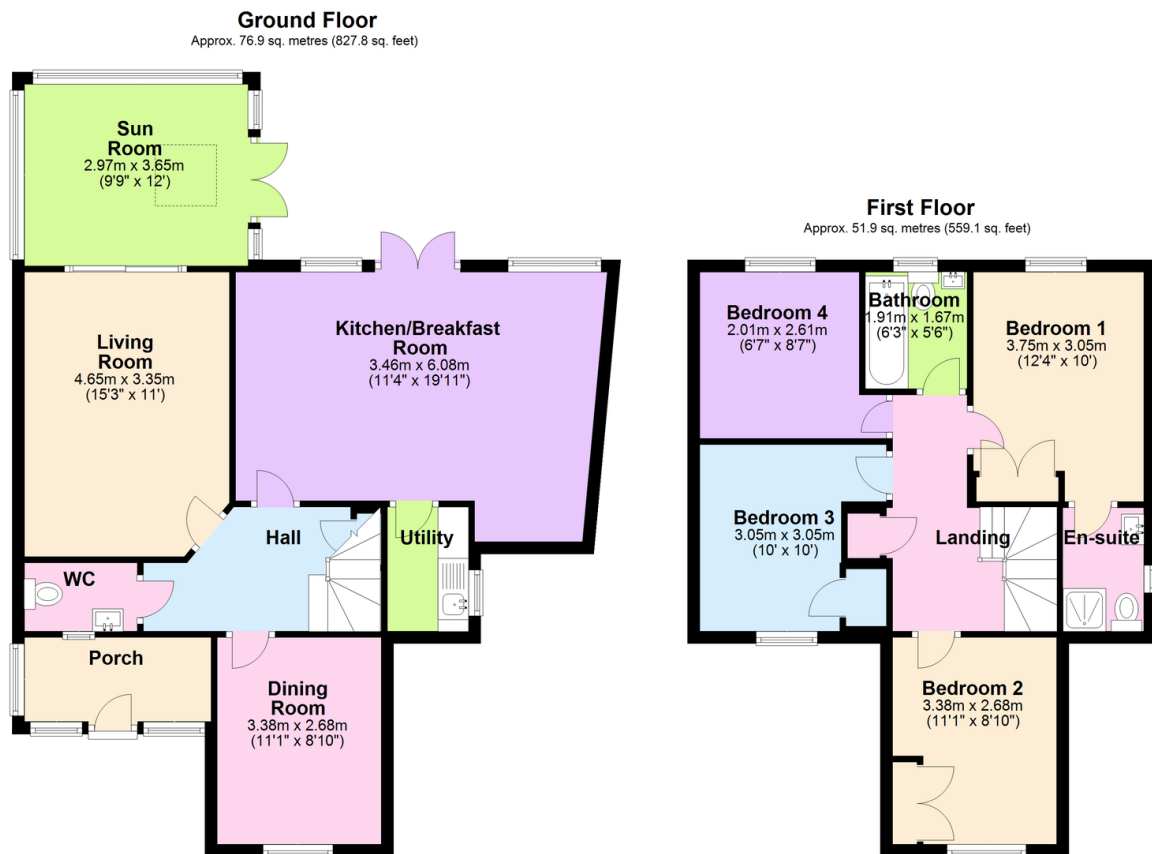

Total area: approx. 128.9 sq. metres (1386.9 sq. feet)