



The logo for Arden Estate Agents, featuring a green house icon above the word "arden" in a bold, white, sans-serif font, with "ESTATE AGENTS" in a smaller, white, sans-serif font below it.

arden
ESTATE AGENTS

It's who
you move
with.

Aversley Road, Kings Norton, Birmingham, B38 8PE

Offers Over £295,000

3 1 2



- Three Bedrooms
- Modern Kitchen
- Family Bathroom
- Driveway for Off Road Parking
- Open Porch
- Spacious Lounge / Diner
- Study Room
- Rear Garden
- Garage
- Close to Amenities





Aversley Road, Kings Norton, Birmingham

Ground Floor

First Floor

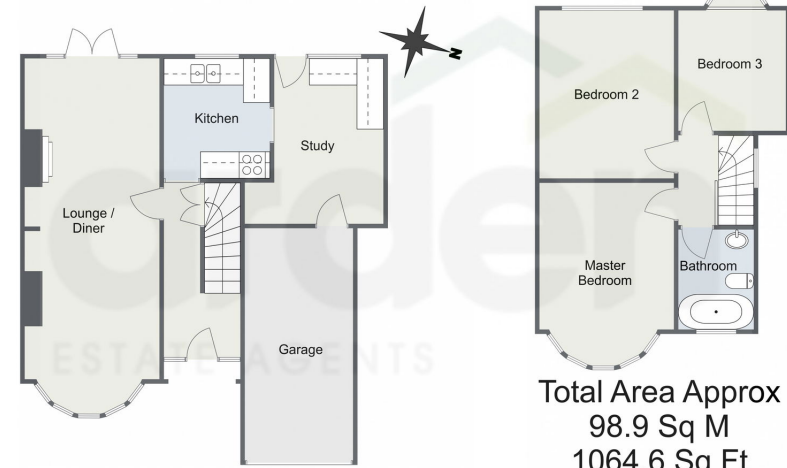

Total Area Approx
98.9 Sq M
1064.6 Sq Ft

For illustrative purposes only. Decorative finishes, fixtures & fittings do not represent the current state of the property. Measurements are approximate & not to scale. Floor plans made using RoomSketcher.

Introducing this well-maintained three-bedroom semi-detached home, complete with a private driveway, garage, open-plan lounge/diner, modern kitchen, additional reception room, family bathroom, and a generously sized rear garden. Situated in the desirable area of Kings Norton, Birmingham, this property is ideal for comfortable family living.

11:52A, 11:32 AM Energy performance certificate (EPC) - Find an energy certificate - GOV.UK

Energy performance certificate (EPC)		
14 Averley Road BIRMINGHAM B38 9PE	Energy rating D	Valid until: 24 January 2033 Certificate number: 8117-8828-4078-0285-2226
Property type	Semi-detached house	
Total floor area	94 square metres	
Rules on letting this property		
Properties can be let if they have an energy rating from A to E.		
You can read guidance for landlords on the regulations and exemptions (https://www.gov.uk/guidance/landlords-on-the-requirements-and-exemptions).		
Energy rating and score		
The graph shows this property's current and potential energy rating.		
This property's energy rating is D. It has the potential to be B.		
Properties get a rating from A (best) to G (worst) and a score. The better the rating and score, the lower your energy bills are likely to be.		
See how to improve this property's energy efficiency.		
For properties in England and Wales: the average energy rating is D the average energy score is 60		

For more information on this house or to arrange a viewing please call the office on:

0121 453 4349

Alternatively, you can scan the QR to view all of the details of this property online.

