



Glenwood Road, Kings Norton, Birmingham, B38 8HF

Offers In Region Of £285,000

3 1 1



- Three Bedrooms
- Kitchen
- Rear Garden
- Garage
- Entrance Hall
- Spacious Lounge / Diner
- Modern Family Bathroom
- Driveway for Off Road Parking
- Secured Porch
- Close to Amenities





Glenwood Road, Kings Norton, Birmingham

Ground Floor

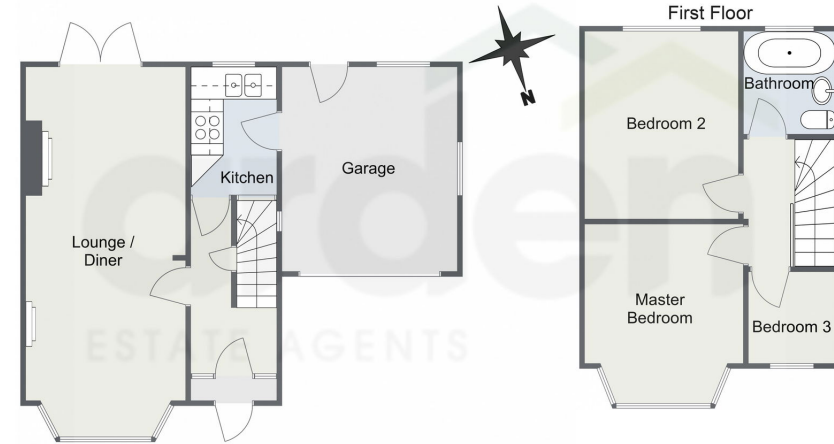

For illustrative purposes only. Decorative finishes, fixtures & fittings do not represent the current state of the property. Measurements are approximate & not to scale. Floor plans made using RoomSketcher.

NO UPWARD CHAIN

Introducing this well-presented three-bedroom semi-detached home, featuring a driveway for off-road parking along with a garage. The property boasts a spacious lounge/diner, a functional kitchen, a stylish modern family bathroom, and a charming rear garden. Conveniently located in the sought-after area of Kings Norton, Birmingham, this home is perfect for comfortable family living.

11:25:24 2:37 PM Energy performance certificate (EPC) - Find an energy certificate - GOV.UK

| Energy performance certificate (EPC) | | |
|---|---------------------------|---|
| 62 Glenwood Road BIRMINGHAM B36 8PT | Energy rating D | Valid until: 20 November 2034 Certificate number: 2170-0139-0040-2098-0723 |
| Property type | Semi-detached house | |
| Total floor area | 62 square metres | |

Rules on letting this property

Properties can be let if they have an energy rating from A to E.

You can read [guidance for landlords on the regulations and exemptions](https://www.gov.uk/guidance/minimum-energy-efficiency-standards-landlord-guidance) (<https://www.gov.uk/guidance/minimum-energy-efficiency-standards-landlord-guidance>).

Energy rating and score

This property's energy rating is D. It has the potential to be B.

[See how to improve this property's energy efficiency.](#)

The graph shows this property's current and potential energy rating.

Properties get a rating from A (best) to G (worst) and a score. The better the rating and score, the lower your energy bills are likely to be.

For properties in England and Wales:
the average energy rating is D
the average energy score is 60

<https://find-energy-certificate.service.gov.uk/energy-certificate/2170-0139-0040-2098-0723/print/view>

14

For more information on this house or to arrange a viewing please call the office on:

0121 453 4349

Alternatively, you can scan the QR to view all of the details of this property online.

