



Beeches Court, 1, Ashill Road, Rednal, Birmingham, B45 9YB

Offers Over £90,000

🛏️ 2 🚿 1 🚻 1



- Over 60s Retirement Complex
- Entrance Hall
- Kitchen
- Parking Area
- Communal Lounge, Laundry Room and Garden
- Two Bedrooms
- Lounge / Diner
- Shower Room
- Full Electric Heating
- Secured Entrances to Building





Beeches Court, Ashill Road, Birmingham

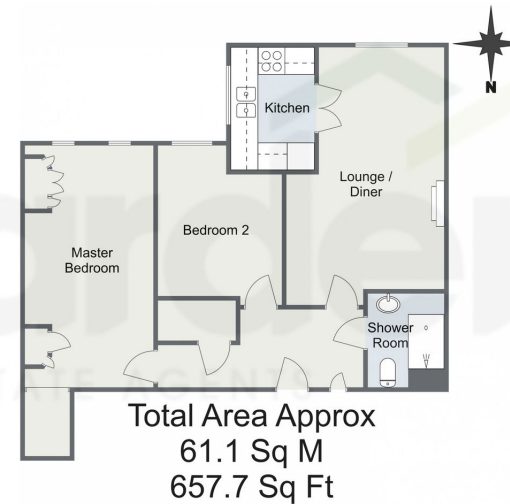

Over 60s Retirement Complex

Introducing this well presented, two bedroom apartment offering an all electric apartment, parking area for the residents, kitchen, size able lounge / diner, communal spaces and a shower room situated in Rednal, Birmingham.

11/02/24, 5:12 PM Energy performance certificate (EPC) - Find an energy certificate - GOV.UK

Energy performance certificate (EPC)		
Flat 44 Beeches Court 1 Ashill Road Birmingham B46 9TS	Energy rating D	Valid until: 30 April 2024 Certificate number: 4708-7536-0322-2322-3443
Property type Top-floor flat	Total floor area 44 square metres	
Rules on letting this property Properties can be let if they have an energy rating from A to E. You can read guidance for landlords on the regulations and exemptions (https://www.gov.uk/guidance/domestic-private-rental-property-minimum-energy-efficiency-standard-landlord-guidance).		
Energy rating and score This property's energy rating is D. It has the potential to be B. See how to improve this property's energy efficiency.		The graph shows this property's current and potential energy rating. Properties get a rating from A (best) to G (worst) and a score. The better the rating and score, the lower your energy bills are likely to be. For properties in England and Wales: the average energy rating is D the average energy score is 60

<https://find-energy-certificate.service.gov.uk/energy-certificates/4708-7536-0322-2322-3443/print.html>

For more information on this house or to arrange a viewing please call the office on:

0121 453 4349

Alternatively, you can scan the QR to view all of the details of this property online.

