

## Greenmoor Avenue, Lofthouse Wakefield

Offers In Region Of £250,000

2 2 1



Ref GC0175 ; So you are looking to downsize the kids have gone and you are fed up of stairs !! then Greenmoor Avenue could be the destination you are looking for. A traditional two bedroom bungalow freshly decorated, new carpets, Modern new kitchen and bathroom recently fitted, Two good size bedrooms with an en suite in main bedroom Cosy lounge with feature fireplace and a detached garage. Add to that a quiet peaceful and well established neighbourhood with easy access to doctors, chemist and local shops and you can see what it has to offer. Lofthouse has great transport links with road, bus and motorway links to Leeds , Wakefield and the rest of the known world on your doorstep. The bungalow has two good size gardens with the rear being south facing it is a pleasant place to sit on a warm evening. It would make a great easy to maintain home that you will love and your family will enjoy. Pack your bags and just move in to your forever home there's no onward chain !!.

- Two bedroom traditional bungalow so no stairs !!
- Spacious modern bathroom
- Peaceful location near all amenities
- EPC Rating C
- Great local transport links
- Modern fitted kitchen
- Newly decorated and new carpets throughout
- Useful utility room and detached garage
- Good size gardens to front and rear

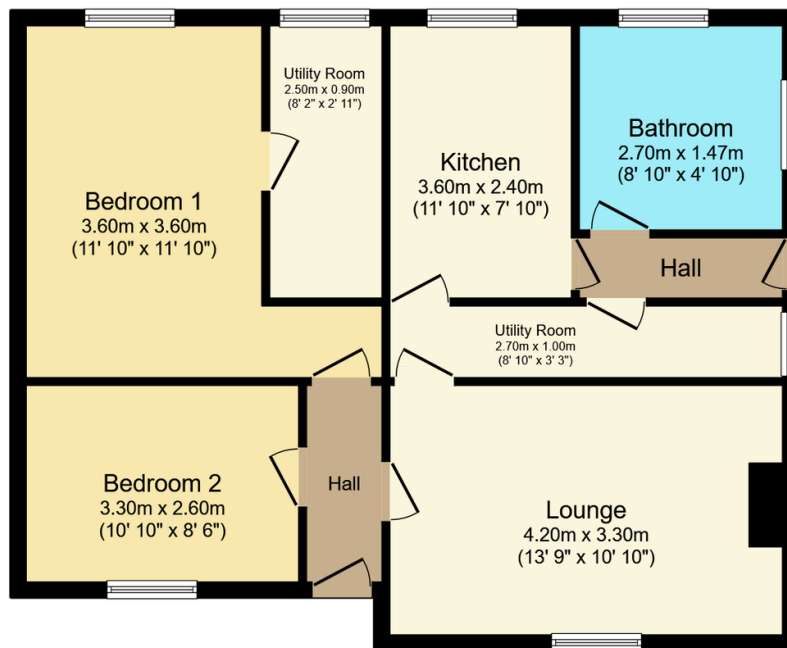

### Floor Plan

Floor area 77.0 sq.m. (829 sq.ft.)

TOTAL: 77.0 sq.m. (829 sq.ft.)

This floor plan is for illustrative purposes only. It is not drawn to scale. Any measurements, floor areas (including any total floor area), openings and orientations are approximate. No details are guaranteed, they cannot be relied upon for any purpose and do not form any part of any agreement. No liability is taken for any error, omission or misstatement. A party must rely upon its own inspection(s). Powered by www.Propertybox.io