



23 Belair Road, Peverell, Plymouth, Devon, PL2 3QH



# Price £250,000

This charming and beautifully presented three-bedroom character home is located in the highly sought-after area of Peverell, offering convenient access to Central Park, local amenities, and excellent schools, and is perfectly suited to a growing family.

The property has been well maintained over the years and still retains many original features such as fireplaces and superb moulded ceilings.

As you step into the property, you're greeted by a spacious entrance hallway, providing access to all ground floor rooms. The lounge and dining room are stylishly designed, creating an ideal space for social gatherings and formal dining. The kitchen is equally impressive, featuring ample worktop and storage space, perfect for those who enjoy cooking, with additional space for a breakfast bar if one wanted. A utility room leads out to the low-maintenance, level rear garden, complete with a rear gate.

Upstairs, boasts three generous bedrooms, the largest, running the full width of the property, and a contemporary, beautifully finished bathroom.

This property truly needs to be seen to be fully appreciated. An internal viewing is highly recommended.

The property has been well maintained over the years and still retains many original features such as fireplaces and superb moulded ceilings.

As you step into the property, you're greeted by a spacious entrance hallway, providing access to all ground floor rooms. The lounge and dining room are stylishly designed, creating an ideal space for social gatherings and formal dining. The kitchen is equally impressive, featuring ample worktop and storage space, perfect for those who enjoy cooking, with additional space for a breakfast bar if one wanted. A utility room leads out to the low-maintenance, level rear garden, complete with a rear gate.

Upstairs, boasts three generous bedrooms, the largest, running the full width of the property, and a contemporary, beautifully finished bathroom.

This property truly needs to be seen to be fully appreciated. An internal viewing is highly recommended.

To view this property call Lang Town & Country Estate Agents on **01752 256000**.





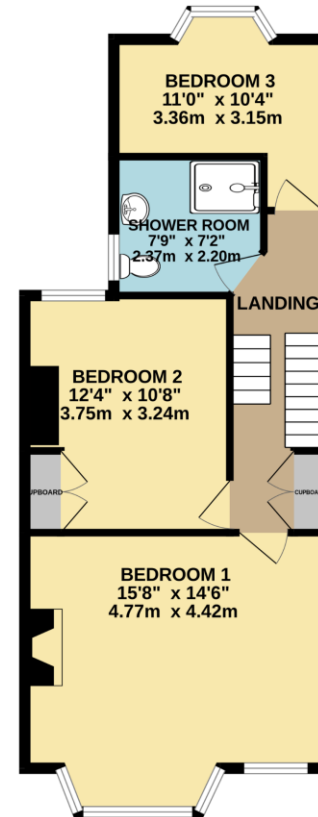
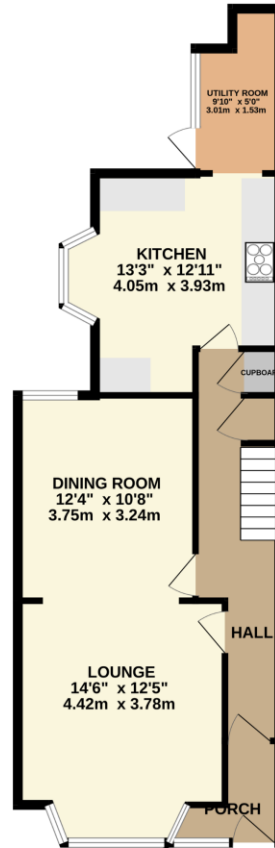

TOTAL FLOOR AREA : 1166 sq.ft. (108.3 sq.m.) approx.

Whilst every attempt has been made to ensure the accuracy of the floorplan contained here, measurements of doors, windows, rooms and any other items are approximate and no responsibility is taken for any error, omission or mis-statement. This plan is for illustrative purposes only and should be used as such by any prospective purchaser. The services, systems and appliances shown have not been tested and no guarantee as to their operability or efficiency can be given.  
Made with Metropix ©2024



Lang Town & Country  
6 Mannamead road  
Mannamead  
Plymouth  
PL4 7AA

Tel: 01752 256000

Email: [property@langtownandcountry.com](mailto:property@langtownandcountry.com)

[www.langtownandcountry.com](http://www.langtownandcountry.com)

Lang Town & Country endeavour to ensure the accuracy of property details produced and displayed, we have not tested any apparatus, equipment, fixtures, fittings or services and so cannot verify that they are connected, in working order or fit for purpose. A buyer must check the availability of any property and make an appointment to view before embarking on any journey to see a property.

