



28 Federation Road, Laira, Plymouth, Devon, PL3 6BR



Offers Over £220,000

Lang Town and Country are pleased to bring to the market this well-presented three-bedroom townhouse, located in the sought-after area of Laira, Plymouth. Known for its convenient access to local schools and the A38 (Devon Expressway), this property is ideal for families and commuters alike. An internal viewing comes highly recommended.

On the ground floor, you'll find a welcoming entrance hallway, a bay-fronted lounge, and a third double bedroom. A graceful staircase leads to the first floor, where there are two spacious double bedrooms and a family bathroom comprising of bath with shower over, wash hand basin, heated towel rail and WC.

The lower ground floor offers additional living space, with a stylish kitchen/breakfast room, a cosy snug/dining space, and an extension area which creates further potential for a separate utility room. The stunning glass balustrade adds a modern touch to the staircase.

Outside, the property features a small front garden, and from the rear you have direct access to a low-maintenance rear garden with artificial grass, positioned to enjoy a sunny south-easterly aspect. There is also gated access to the rear service lane, offering potential for additional parking.



To view this property call Lang Town & Country Estate Agents on **01752 256000**



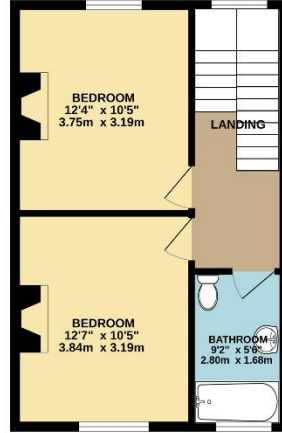
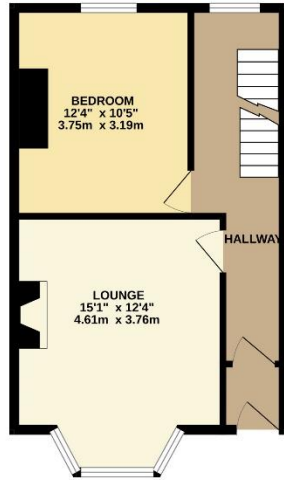
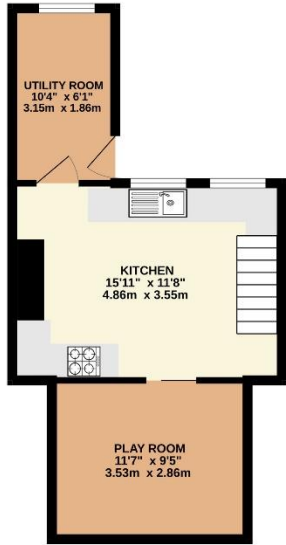

TOTAL FLOOR AREA: 1167 sq.ft. (108.5 sq.m.) approx.
 Whilst every attempt has been made to ensure the accuracy of the floorplan contained here, measurements of doors, windows, rooms and any other items are approximate and no responsibility is taken for any error, omission or mis-statement. This plan is for illustrative purposes only and should be used as such by any prospective purchaser. The services, systems and appliances shown have not been tested and no guarantee as to their operability or efficiency can be given.
 Made with Metropix ©2024



Lang Town & Country
 6 Mannamead Road
 Plymouth
 PL4 7AA
 Tel: 01752 256000
 Email: property@langtownandcountry.com
www.langtownandcountry.com

Lang Town & Country endeavour to ensure the accuracy of property details produced and displayed, we have not tested any apparatus, equipment, fixtures, fittings or services and so cannot verify that they are connected, in working order or fit for purpose. A buyer must check the availability of any property and make an appointment to view before embarking on any journey to see a property.

