



## Rimsdale Close, Gatley

Offers In Region Of £350,000

3 1 1

- Detached Bungalow
- Three Well Proportioned Bedrooms
- Three Bathroom with Separate W.C
- Excellent End Garden Plot
- Garage with Electric Up and Over Door
- Spacious Lounge
- Lawn Gardens to the Front and Rear
- Extensive Off Road Parking
- Offered for Sale with No Chain
- Tenure - Freehold / EPC - C / Council Tax Band - D



A delightful THREE BEDROOM DETACHED BUNGALOW, situated at the HEAD OF THIS QUIET CUL DE SAC, within WALKING DISTANCE OF GATLEY VILLAGE. The accommodation comprises of a entrance hallway opening to the kitchen and large lounge, dining room, conservatory, three double bedrooms served by a three piece family bathroom suite with separate W.C. Externally, there is a large driveway to the front with established lawn gardens to the front and rear. Offered for sale with no onward chain.





GROUND FLOOR  
926 sq. ft. (86.0 sq.m.) approx.

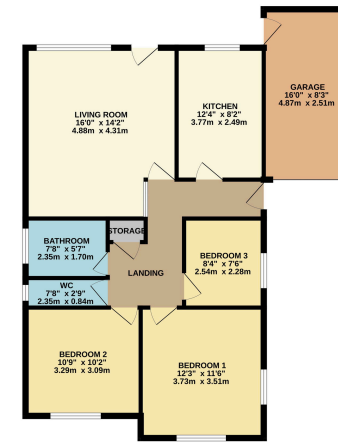

TOTAL FLOOR AREA: 926 sq. ft. (86.0 sq.m.) approx.  
 While every effort has been made to ensure the accuracy of the floor plan, the measurements of the rooms, areas, volumes, etc. are not guaranteed and are subject to change without notice. The actual, current and prospective plans have not been used and are provided as a guide only.  
 www.andrewdawson.co.uk

