



## 19 Larchwood, The Crescent

£122,500

🛏️ 1 🚿 0 🚻 0

- One Double Bedroom Apartment
- Newly Fitted Kitchen with Integrated Appliances
- Cheadle Village Conservation Area Location
- Communal Lounge, Laundry and Garden areas.
- Parking Spaces can be Rented Dependent upon Availability.
- First Floor Position within the Development
- Stylish White Shower Room
- Beautifully Appointed Throughout
- Lift To All Floors and Garden areas.
- EPC - C / Tenure - Leasehold / Council Tax Band - C







GROUND FLOOR  
465 sq.ft. (43.2 sq.m.) approx.

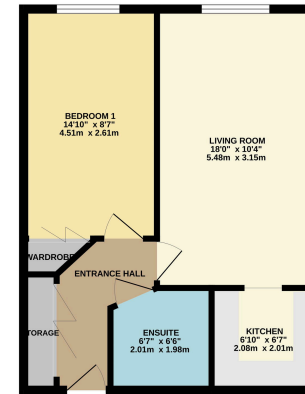

TOTAL FLOOR AREA: 465 sq.ft. (43.2 sq.m.) approx.  
 While every effort has been made to ensure the accuracy of the floor plan, the seller does not warrant its accuracy. The floor plan is provided for information only and should not be relied upon for any legal or financial purposes. The actual layout and dimensions may vary from those shown on the floor plan.

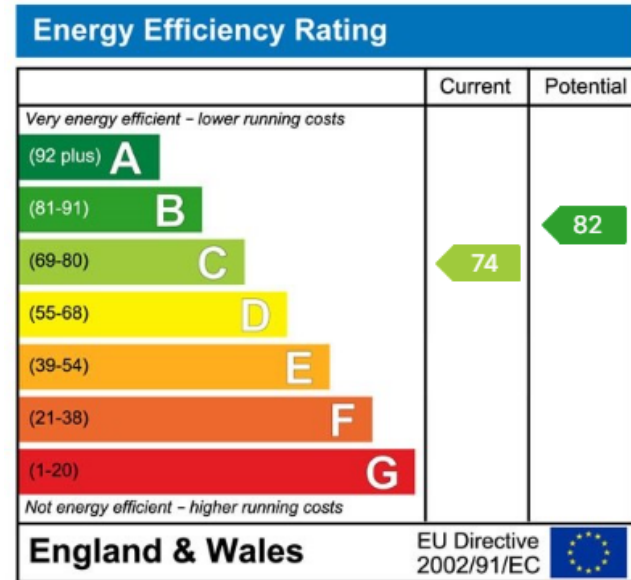

9 Gatley Road, Cheadle, Cheshire SK8 1LY Tel. 0161 428 1488 Fax. 0161 428 1479  
 Email. [mail@andrewdawson.co.uk](mailto:mail@andrewdawson.co.uk)