



Salisburys

Tavistock, PL19 8ER
Offers Over £210,000

🛏 2 🚿 1 🛋 1



- 2 bedroom end of terrace
- Modern Kitchen
- Open plan Lounge/Dining Room
- French door to rear garden
- Modern Shower Room
- Well maintained
- Enclosed courtyard garden
- En-bloc Garage and parking space
- Gas central heating
- Good location



Well-Presented Two-Bedroom End-Terrace Home with Garage. Situated in the popular Monksmead area, this well-maintained two-bedroom end-terrace home offers a combination of comfort and location. With the added benefits of a garage and a secure rear garden, it's an ideal choice for first-time buyers, downsizers, or investors. Enter via the entrance porch into the bright and spacious lounge/dining room benefitting from natural light leading into a separate, well-appointed kitchen. French doors open out onto a low-maintenance patio garden, providing a space for outdoor dining/relaxation. Upstairs, the property offers two generous double bedrooms, with built-in wardrobes. The family shower room features white sanitary ware and a walk-in shower. To the front is a landscaped garden with decorative gravel and mature shrubs, while the garage ensure practical day-to-day living. This charming home is not to be missed.

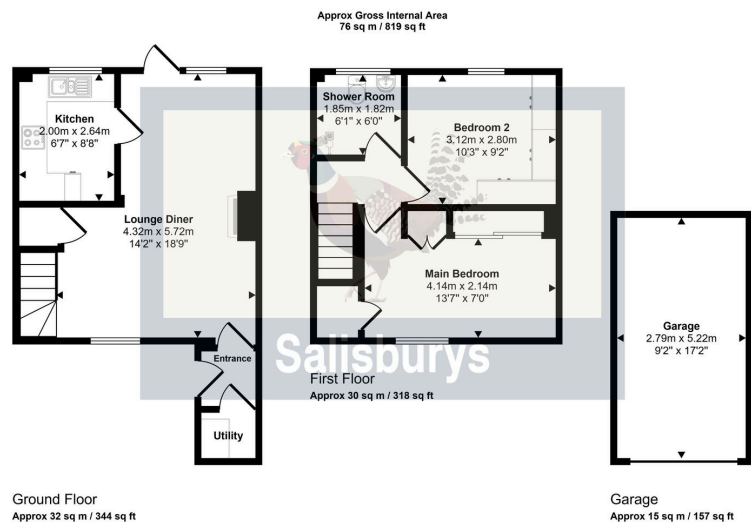

This floorplan is only for illustrative purposes and is not to scale. Measurements of rooms, doors, windows, and any items are approximate and no responsibility is taken for any error, omission or mis-statement. Icons of items such as bathroom suites are representations only and may not look like the real items. Made with Made Snappy 360.

| Score | Energy rating | Current | Potential |
|-------|---------------|---------|-----------|
| 92+ | A | | 112 A |
| 81-91 | B | | |
| 69-80 | C | 69 C | |
| 55-68 | D | | |
| 39-54 | E | | |
| 21-38 | F | | |
| 1-20 | G | | |

