



Bedford Bridge, Yelverton, PL20 7RZ

£595,000



Bedford Bridge, Yelverton, PL20 7RZ

This beautiful CHARACTER PROPERTY with FOUR BEDROOMS, FOUR BATHROOMS and parking for MULTIPLE VEHICLES must be viewed to fully appreciate the accommodation and grounds. The White House is a very attractive property which offers versatile and flexible accommodation briefly comprising of:- Lounge with log burner and feature fireplace, Kitchen/Dining Room with oak units and large island, Utility Room and downstairs Shower Room, separate Dining Room, two further reception rooms, four large double bedrooms and three upstairs bathrooms (one en-suite). Externally the property has a double garage which is currently a workshop, gardens, a private Sun Terrace and parking for multiple vehicles. **MUST BE VIEWED!**

The property has huge kerb appeal and has formerly been a Public House and workman's cottage before being combined into one building. The current owners originally ran a successful B&B at the house so the property provides the opportunity for a business venture subject to consent from Dartmoor National Park Authority. The main entrance to the property is via a stable door framed by a well established wisteria.





On entering the property there is a spacious Lounge with a stunning feature fireplace with a slate hearth and solid oak mantle across the width of the chimney breast with alcoves to either side. The room also has a deep panelled window seat overlooking the gardens and this room leads through to the Kitchen/ Dining room with a full range of base and wall units in oak and a large matching oak island and oak flooring. The Kitchen has a triple oil fired Aga, double butler sink and dishwasher with a separate seating area that overlooks the Sun Terrace. From the Kitchen, there is access to the separate Dining Room, Reception Two, the rear Utility Room, Shower Room and the Sun Terrace.

Upstairs, the property offers a Master Bedroom with vaulted ceiling and exposed brickwork and separate Shower Room, Bedroom Two has its own large En-suite bathroom, Bedroom Three is a large double bedroom with a dual aspect and Bedroom Four, again a large double bedroom also has its own En-suite. All rooms have double glazed windows with additional secondary glazing.





Externally: The property has a part paved, part gravelled driveway with parking for multiple vehicles and a pitched roof double garage to the side of the property that is currently used as a workshop. The Sun Terrace is situated in a secluded position between the garage and the rear of the property that provides a sheltered and private area for al fresco dining or soaking up the sun. There are mature gardens to the front of the property which are laid to lawn with trees and shrubs and the gardens to the side of the property lead to a well maintained raised vegetable bed and a further patio area with apple and pear trees that are fan-trained to be a feature "wall" to the additional seating area.

Services: Oil fired central heating, mains electric, private water supply and Sess pit.

EPC Rating: D (59)

Directions: From Bedford Square take the A386 towards Plymouth. Continue towards Plymouth and just over Bedford Bridge, before Horrabridge The White House can be found on the left hand side.

Agents Note: Fixtures, fittings, appliances or any building services referred to does not imply that they are in working order or have been tested by us. The suitability and working condition of these items and services is the responsibility of purchasers.



Approx Gross Internal Area
249 sq m / 2678 sq ft

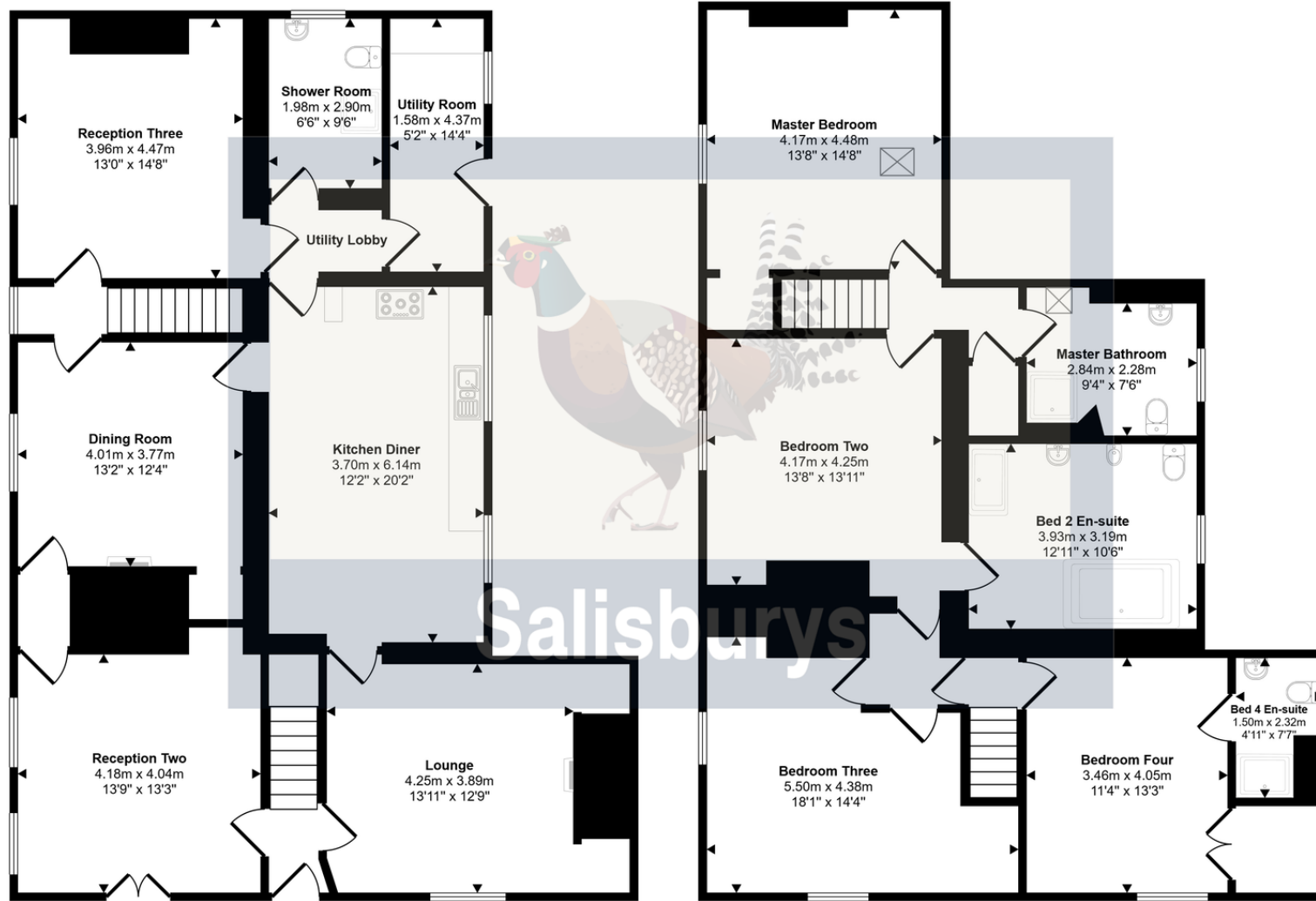

Ground Floor
Approx 130 sq m / 1401 sq ft

First Floor
Approx 119 sq m / 1277 sq ft

This floorplan is only for illustrative purposes and is not to scale. Measurements of rooms, doors, windows, and any items are approximate and no responsibility is taken for any error, omission or mis-statement. Icons of items such as bathroom suites are representations only and may not look like the real items. Made with Made Snappy 360.

