



Salisburys



Parkwood Road, Tavistock, PL19.

Offers In Region Of £240,000

🛏 2 🪴 1 🛋 2





- Attractive end of terrace period home
- Through lounge/dining room
- Family bathroom - modern white suite with electric shower
- Gated side access to rear
- Flat walk to Town and shops
- 2 good sized double bedrooms
- Well fitted kitchen with integrated appliances
- Double glazing throughout
- Patio doors to garden
- NO ONWARD CHAIN



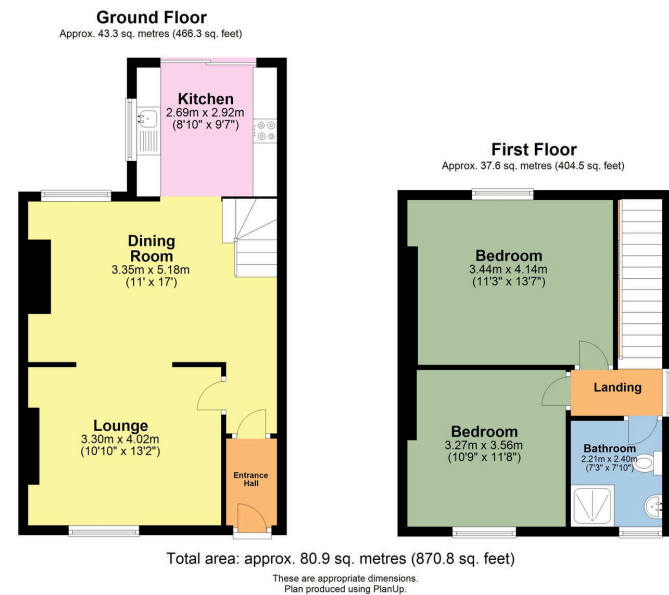

Located in a much sought after residential road, an end of terrace, two bedroom Victorian property which is a short flat walk into the centre of Tavistock. The property which is neutrally decorated throughout, offers the benefit of a through Lounge/Dining Room, a separate kitchen with integrated appliances, patio doors to the rear, two good sized double bedrooms and a large Family Bathroom. Externally, the rear garden offers both a lawned area and a patio with a useful storage shed to the side. The garden can also be accessed through a gated side entrance.

Score	Energy rating	Current	Potential
92+	A		
81-91	B		86 B
69-80	C		
55-68	D	61 D	
39-54	E		
21-38	F		
1-20	G		