



Salisburys

Canons Way, PL19.

£270,000

3 1 2



- Three bedroom semi-detached home
- Fully fitted kitchen
- Conservatory
- Front and Rear Gardens
- NO ONWARD CHAIN
- Well presented throughout
- Lounge/Dining room
- Driveway parking for several vehicles
- Close to Canal and a flat walk to Town
- NEW VIEWING DAY FRIDAY 31st JANUARY



First to see will buy! Located in the popular development of Canons Way, close to the Canal which offers a level walk into the town of Tavistock is this 3 bedroom semi-detached family home. Well presented and offering spacious family living sitting on a large corner plot which provides the added advantage of more garden area. Off-street parking is available for several vehicles to the rear of the property. NO ONWARD CHAIN.

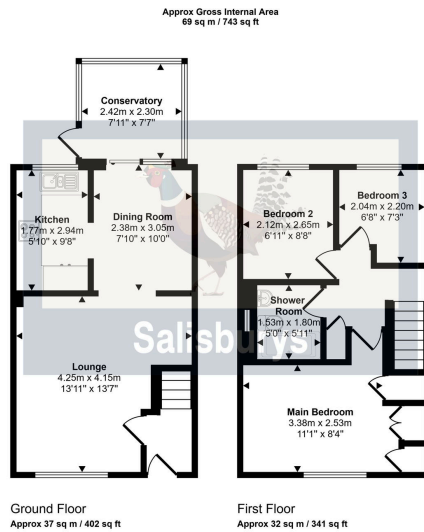

This floorplan is only for illustrative purposes and is not to scale. Measurements of rooms, doors, windows, and any items are approximate and no responsibility is taken for any error, omission or mis-statement. Icons of items such as bathroom suites are representations only and may not look like the real items. Made with Made Snappy 360.

Score	Energy rating	Current	Potential
92+	A		
81-91	B		86 B
69-80	C	70 C	
55-68	D		
39-54	E		
21-38	F		
1-20	G		

