



Lampards

lampards.co.uk
0208 208 0055
info@lampards.co.uk

4a Lonsdale Road,
Queens park,
NW6 6RD

Roundwood Road,
Offers Over £550,000

🛏 2 🚿 1 🚿 1



This beautifully extended two-bedroom maisonette offers a perfect blend of contemporary style and thoughtful design, complemented by a charming south-facing garden. Enter through your own private front door and step into a home that exudes both character and comfort, with every detail carefully considered.

The property features two spacious double bedrooms, both equally sized, bright, and well-proportioned. A stylish family bathroom, complete with a separate utility cupboard, provides practical living without compromising on design.

The heart of the home is the impressive, open-plan kitchen and living area at the rear, where modern luxury meets industrial charm. Exposed steel beams add a striking, contemporary edge to the space, while maintaining a warm and welcoming atmosphere. The kitchen is fully equipped with high-end appliances, including an integrated oven, induction hob, fridge-freezer, and a separate drinks fridge—ideal for those who love to entertain.

Full-width bi-fold doors open directly onto a pristine, southwest-facing garden. With a large patio area perfect for al fresco dining, an immaculate artificial lawn for easy maintenance, and a handy garden shed, this outdoor space is a true extension of the home.

Located on Roundwood Road, this maisonette is just moments from the lush green expanses of Roundwood Park and benefits from excellent transport links via Dollis Hill Station.



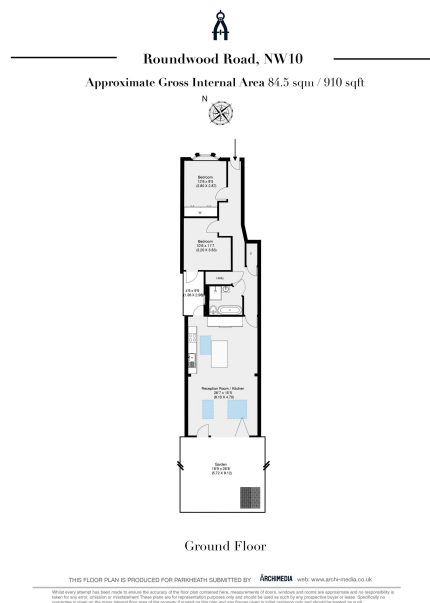

- Beautifully extended two-bedroom maisonette.
- Two spacious double bedrooms, equally sized.
- Stunning open-plan kitchen and living space.
- Modern kitchen with high-end integrated appliances.
- Large patio and easy-maintenance artificial lawn.
- Private front door with independent access.
- Stylish family bathroom with separate utility cupboard.
- Exposed industrial-style steel beams.
- Bi-fold doors opening onto a southwest-facing garden.
- Close to Roundwood Park and Dollis Hill Station.



| Score | Energy rating | Current | Potential |
|-------|---------------|---------|-----------|
| 92+ | A | | |
| 81-91 | B | | |
| 69-80 | C | 75 C | 77 C |
| 55-68 | D | | |
| 39-54 | E | | |
| 21-38 | F | | |
| 1-20 | G | | |