

Thanet Lodge, Mapesbury Road, NW2

Guide Price £499,950

🛏 2 🍳 2 🛋 1



A stunning two-bedroom apartment in the sought after Mapesbury Conservation Area, offering elegant interiors, a modern finish, and a long lease. The bright and spacious reception room is perfect for relaxing and entertaining, while the separate well-equipped kitchen features sleek stone worktops and integrated appliances. Both double bedrooms include custom built-in wardrobes, with the second benefiting from a stylish en-suite. A further modern bathroom, professional soundproofing, and smart gas central heating add to the comfort. The west-facing aspect ensures natural light floods the space throughout the day. Set within a well-maintained development with lift access and communal gardens, the property is moments from multiple transport links, shops, and green spaces.

Key Features

- Professional Soundproofing
- Beautiful Two Double Bedroom Purpose Built Flat
- Sought After Mapesbury Conservation Area Location
- Elegant Interiors and Modern Finish
- Bright and Spacious Reception Room and Separate Well-Equipped Kitchen
- Two Modern Bathrooms
- Well-Maintained Communal Gardens and Lift Access
- Long Lease (956 years remaining)
- Close to Transport Links and Amenities
- Book your viewing with Lampards

Lampards

Thanet Lodge, Mapesbury Road, London, NW2

Approximate Floor Area = 72.7 Sq m / 782 Sq ft
For Illustrative Purposes Only NOT TO SCALE

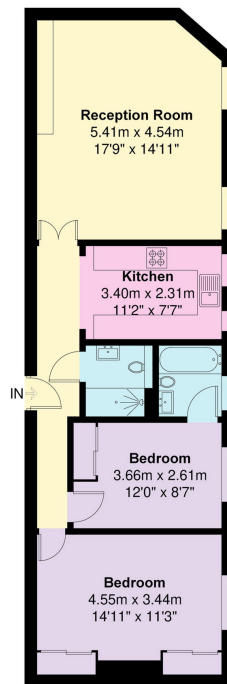

Second Floor



This Floorplan is been produced in accordance with RICS Property Measurements Standards (IPMS2 Residential) Floorplan was produced for Lampards.
Produced by GreyArrowStudios