



Lampards

lampards.co.uk  
0208 208 0055  
info@lampards.co.uk

4a Lonsdale Road,  
Queens park,  
NW6 6RD



Fernhead Road,  
£350,000

1 1 1



Set within an attractive period conversion on Fernhead Road, this well-presented 1-bedroom ground floor flat offers a bright and practical layout with access to a beautifully maintained communal garden—an ideal outdoor retreat in a prime W9 location.

Occupying approximately 432 sqft, the flat opens into a hallway that leads into a light-filled reception room, enhanced by large windows and garden-facing views. Adjacent is a separate galley-style kitchen, efficiently laid out and fitted with essential appliances and storage.

The double bedroom is positioned quietly to the rear, offering generous proportions and space for wardrobes. A compact but neatly arranged bathroom completes the internal accommodation.

This flat is ideal for first-time buyers, professionals, or those seeking a London base with garden access, within a well-connected and vibrant residential setting.

The flat benefits from use of a large communal rear garden, offering residents a peaceful shared outdoor space—perfect for enjoying the warmer months without the upkeep of a private garden. The garden is well-maintained and provides space for sitting out, reading, or relaxing.

Fernhead Road sits between Queen's Park and Maida Vale, both sought-after neighbourhoods known for their leafy streets, period architecture, and strong community feel.

This charming ground-floor 1-bedroom flat has a well-designed layout, and communal garden access, all within one of West London's most desirable postcodes. Located on a quiet street just moments from green spaces, transport links and vibrant high streets, the flat offers an ideal balance of tranquillity and connectivity.

Perfect as a first-time purchase, London pied-à-terre, or a low-maintenance rental investment.







- Spacious one bedroom ground floor flat
- High Ceilings and natural light
- Direct access to communal garden
- Excellent location
- Long lease
- Perfect for first time buyer or rental investor
- Well presented throughout
- Close to all amenities
- Walking distance to Queens Park & Madigan Vale
- Excellent transport links (bakerloo Line & Overground)



Lampards



**Fernhead Road, W9**  
Approximate Floor Area = 40.2 Sq m / 432 Sq ft  
For Illustrative Purposes Only NOT TO SCALE

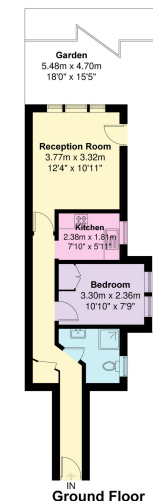

This Floorplan is based on measurements taken from RICS Property Measurements Standards (IPMS) Residential Floorplan was produced for Lampards, Produced by Prime Focus Studios

