

## Monastery Drive, Solihull, B91 1DP

Offers Over £600,000

3 1 2



This delightful three-bedroom detached bungalow offers a blend of comfortable living, versatile spaces, and extensive outdoor areas, ideal for those downsizing, retirees, or anyone looking for a property with scope for future development.

## Key Features

- Three Bedroom Detached Bungalow
- Dining Kitchen
- Shower Room
- Lovely Rear Garden
- Versatile Living
- Garage
- Large Loft Room
- Viewings Highly Recommended

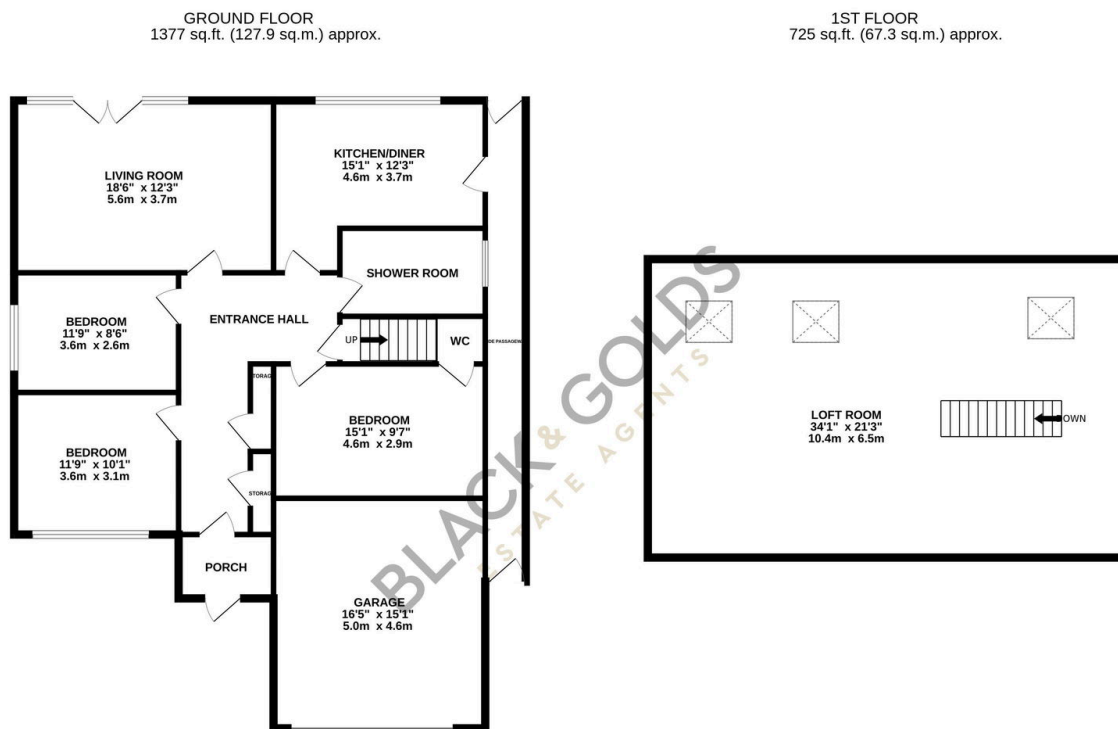

TOTAL FLOOR AREA: 2102 sq.ft. (195.3 sq.m.) approx.

Whilst every attempt has been made to ensure the accuracy of the floorplan contained here, measurements of doors, windows, rooms and any other items are approximate and no responsibility is taken for any error, omission or mis-statement. This plan is for illustrative purposes only and should be used as such by any prospective purchaser. The services, systems and appliances shown have not been tested and no guarantee as to their operability or efficiency can be given.

Made with Metropix ©2024