



FINE & COUNTRY

20 Church Street,  
£250,000

3 1 1



- Delightful 3 Bedroom Cottage • Exceptional Standard Throughout
- Bursting with Charm & Character
- Sought After Location
- Open countryside on the Doorstep
- Close to Sheffield Centre
- Off Road Parking / Rear Garden
- Abundance of Local Facilities
- Access to Train & Bus Services
- Viewing Advised



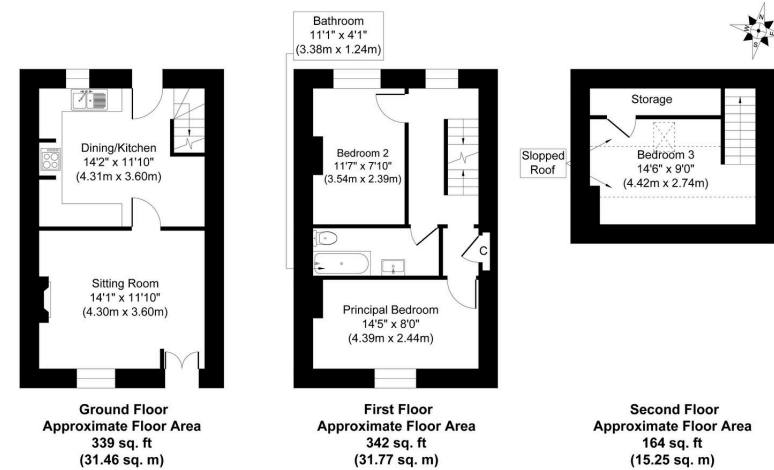

Whilst every attempt has been made to ensure the accuracy of the floor plan contained here, measurements of doors, windows, rooms and any other items are approximate and no responsibility is taken for any error, omission, or mis-statement. The measurements should not be relied upon for valuation, transaction and/or funding purposes. This plan is for illustrative purposes only and should be used as such by any prospective purchaser or tenant. The services, systems and appliances shown have not been tested and no guarantee as to their operability or efficiency can be given.  
Copyright V360 Ltd 2024 | www.houseviz.com

A delightful, terraced cottage, tastefully presented and sympathetically modernised with retained period features, offering spacious accommodation incorporating two first floor bedroom and a second floor attic room, enjoying an idyllic village setting on the edge of open countryside whilst being within a short walk of an abundance of village amenities.

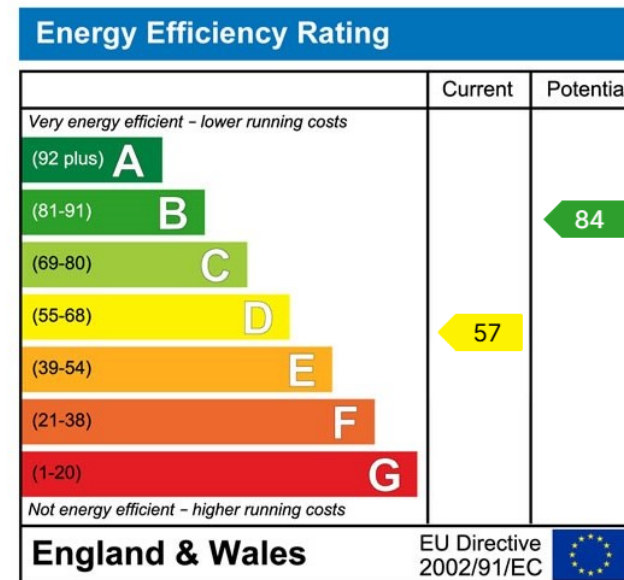

House 42, Locke, 44 Shambles St,  
Barnsley S70 2SH  
Tel: +44 (0)01226 729009  
barnsley@fineandcountry.com

Unit 2 Former Council Offices, Eastgate  
Honley, Holmfirth HD9 6PA  
Tel: +44 (0)1484 550620  
huddersfield@fineandcountry.com

The Balance Floor 7, 2 Pinfold Street  
Sheffield, South Yorkshire S1 2GU  
Tel: +44 (0)114 404 0044  
sheffield@fineandcountry.com