



Leysdown Road, Mottingham, SE9

Offers Over £765,000

🛏 3 🚿 2 🚗 1



- Three Bedroom Family Home
- Extended Open Plan Kitchen/ Dining Area With Sky-Light Window & Bi-Fold Doors
- Two Bathrooms
- Generous Garden To Rear
- Off Street Parking & Garage
- Walking Distance Of Mottingham Railway Station
- Excellent Bus Links Keeping You Connected With Bromley, Chislehurst & Eltham
- Close Proximity To Highly Regarded Nurseries & Schools
- Easy Reach Of Mottingham Village Shops, Eateries & Leisure Facilities
- Council Tax Band E - Royal Borough Of Greenwich



*** Offers Over £765,000 ***

Cockburn are pleased to present to the market a chance to become the proud owner of this contemporary, versatile, modern and spacious family home, which has been extended and now spans approximately 1,757 square feet.

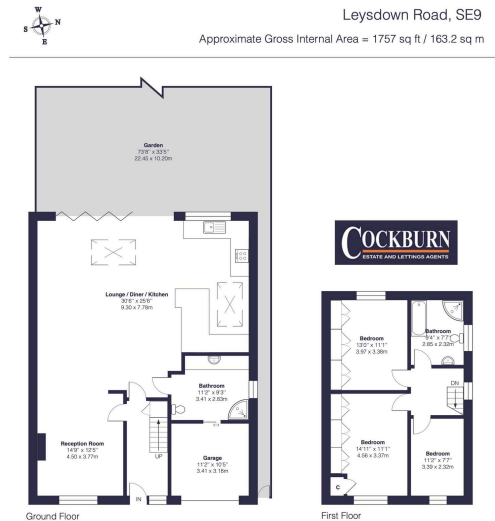

This plan is for layout guidance only and not drawn to scale unless stated. Window and door openings are approximate. Whilst every care is taken in the preparation of this plan, we would advise interested parties to check all dimensions, shapes and compass bearings prior to making any decisions reliant upon them.
By Homebook.co.uk / Copyright 2020

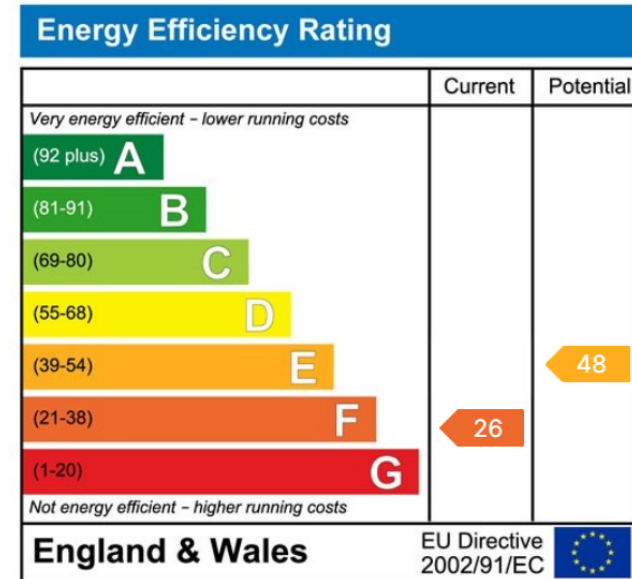

Cockburn EA

352 Footscray Road,
London, SE9 2EB

t: 020 8859 8590