



## Russell Road, Newbury, Berkshire, RG14 5JX

Guide Price £315,000

 2  1  1

- Mid-terrace character property
- Large living/dining room
- St Barts school catchment
- Utility/store
- No onward chain
- Two bedrooms
- Walk to town/rail station
- Large rear garden
- Gas central heating
- On-street parking



Smartly presented two bedroom mid-terrace character property, situated on this popular residential road, within walking distance of the town centre/rail station and St Barts secondary school. The accommodation comprises entrance hall, large dual aspect living/dining room, kitchen, utility area, main double bedroom, further bedroom and bathroom. Benefits include a good size rear garden, gas central heating and **NO ONWARD CHAIN**.



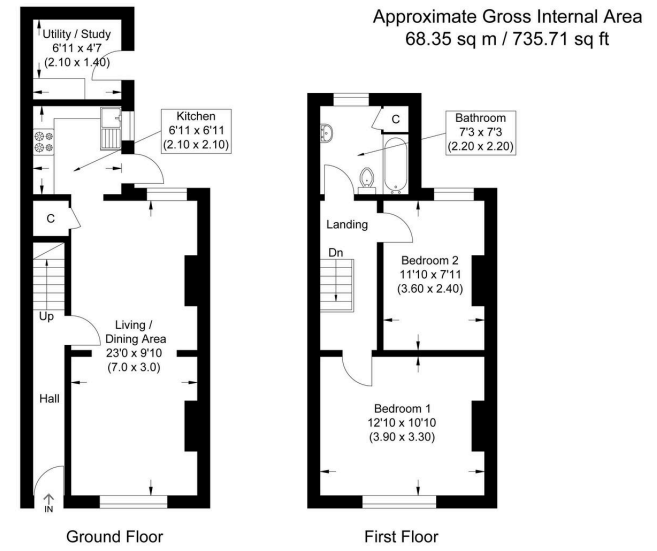
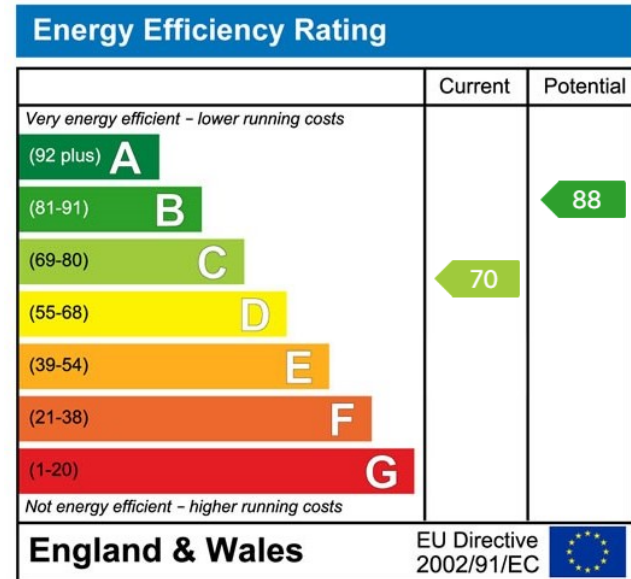

Illustration for identification purposes only, measurements are approximate, not to scale.



☎ 01635 523777 (Sales)

☎ 01635 523880 (Lettings)

🌐 [www.downer.co.uk](http://www.downer.co.uk)