



**HENDERSON
CONNELLAN**
ESTATE AGENTS

Thurston Drive, Kettering, NN15

"Big just got Bigger"

🛏️ 1 🪑 1 🚿 1



"Big just got Bigger"

You will be amazed by the space of this fabulous, modern, first floor maisonette situated on the extremely sought after Leisure village. The leisure centre, theatre, pub, shop, town centre and mainline railway are all within easy reach. With its very own access, the stunning interior offers clean contemporary lines with an entrance hall, generous landing leading to a stylish living room providing both living and dining options which flows to a designer Kitchen/Breakfast room with integrated oven and hob. The main bedroom is an epic double room with built in wardrobe and a cool white contemporary bathroom. Gas central heating and UPVC double glazing complete the inside. Outside there is allocated parking on a block paved driveway. Come and see this fabulous home first hand!!

Living Room - 4.65m x 3.07m (15'3" x 10'1")

Kitchen - 4.65m x 2.39m (15'3" x 7'10")

Bedroom 1 - 4.62m x 3.45m (15'2" x 11'4")

Bathroom - 2.29m x 1.93m (7'6" x 6'4")



Ground Floor

Approx. 58.9 sq. metres (633.8 sq. feet)

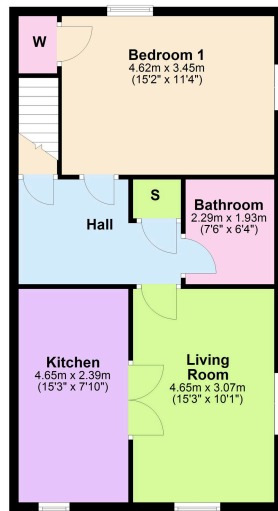

Total area: approx. 58.9 sq. metres (633.8 sq. feet)

- Leasehold - the two residents own the Freehold
- Private Parking for one Car
- Impressive Double Bedroom with built in Wardrobe
- Designer Kitchen/Breakfast Room with integrated oven and hob
- Living Room providing both Living and Dining Options
- First Floor Maisonette with a very generous interior
- UPVC Double Glazed
- Gas Central Heating
- Council Tax: A
- EPC Rating: B



Disclaimer: These particulars do not form part of any offer or contract and should not be relied upon as statements or representations of fact. Any areas, measurements of distances are approximate. The text, photographs and plans are for guidance only and are not necessarily comprehensive.

15-16 Market Place, Kettering,
Northamptonshire, NN16 0AJ

