



**HENDERSON
CONNELLAN**
ESTATE AGENTS

Cherry Road, Kettering NN16

"Room to Grow"

3 1 0



"Room to Grow"

This fabulous semi detached home occupies a substantial corner plot, with wrap around gardens with private driveway for two cars and a well kept rear garden, offering lots of potential to extend. (subject to planning). The interior has been improved and enhanced featuring Gas central heating and UPVC double glazed Windows to include an entrance hall, living/dining room with impressive exposed brick fireplace, stunning kitchen with integrated oven and hob, butler sink and oak work surfaces, walk in cupboard and laundry room. Upstairs there is a cool white designer shower room and three bedrooms two of which are double sized. This home has never looked so good!

Living/Dining Room - 4.42m x 4.37m (14'6" x 14'4")

Kitchen - 4.39m x 2.36m (14'5" x 7'9")

Bedroom One - 4.14m x 3.18m (13'7" x 10'5")

Bedroom Two - 3.2m x 2.69m (10'6" x 8'10")

Bedroom Three - 3.12m x 2.16m (10'3" x 7'1")

Shower Room - 2.08m x 1.78m (6'10" x 5'10")





- Gas Central Heating
- Living Room with attractive feature fireplace
- Three Bedrooms and a designer shower room
- EPC RATING: PENDING
- UPVC Double Glazing
- Kitchen with Oak Style worksurfaces
- Corner plot with wrap around gardens and parking for two cars
- Council Tax: A

Ground Floor

Approx. 37.1 sq. metres (399.3 sq. feet)

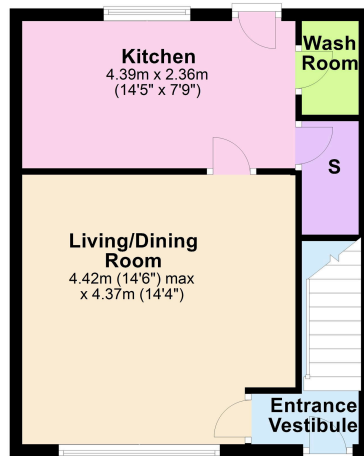

total area: approx. 75.1 sq. metres (808.4 sq. feet)

First Floor

Approx. 38.0 sq. metres (409.1 sq. feet)

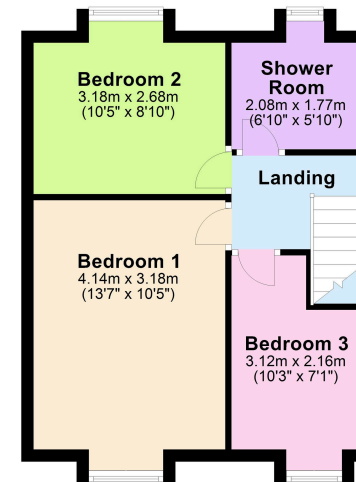

Disclaimer: These particulars do not form part of any offer or contract and should not be relied upon as statements or representations of fact. Any areas, measurements of distances are approximate. The text, photographs and plans are for guidance only and are not necessarily comprehensive.

15-16 Market Place, Kettering,
Northamptonshire, NN16 0AJ

