



**HENDERSON
CONNELLAN**
ESTATE AGENTS

Old Road, Walgrave NN6

"Countryfile"

🛏️ 2 🚿 1 🚗 2



"Countryfile"

Views of Rolling Countryside can be admired every day along with the spectacle of the changing seasons from this lovely period bay fronted home situated on the periphery of this most desirable village. A country pub, shop, picturesque Church and a primary school can all be found within the village, rural walks are on your doorstep yet Kettering, Northampton and Wellingborough are all within easy reach.

The stylish interior enjoys a fusion of period and contemporary design with a living room with bay window and feature fireplace, fabulous designer kitchen/dining/family room with select integrated appliances, a great social space with double doors to the garden. Upstairs there is a principal bathroom and two double bedrooms both with attractive fireplaces, the main bedroom also has an ensuite wash room. Gas central heating and UPVC double glazing complete the inside. Outside the foregarden is arranged with easy care in mind, the fabulous rear garden has been landscaped, a generous patio is the perfect vantage point from which to sit and admire the view!!
Stunning!

Living Room - 3.66m x 3.66m (12'0" x 12'0")

Dining Room - 3.66m x 3.58m (12'0" x 11'9")

Kitchen - 3.86m x 1.93m (12'8" x 6'4")

Family Room - 2.44m x 2.41m (8'0" x 7'11")

Bedroom 1 - 4.85m x 3.66m (15'11" x 12'0")

Bedroom 2 - 3.86m x 3.61m (12'8" x 11'10")

Bathroom - 3.89m x 1.93m (12'9" x 6'4")

Ensuite - 1.55m x 0.76m (5'1" x 2'6")





- Village Location
- Two Bedrooms
- Countryside View to the Rear
- Ensuite Wash Room
- First Floor Bathroom
- Period Features
- Council Tax: C
- EPC RATING: D

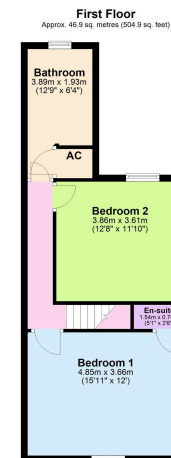
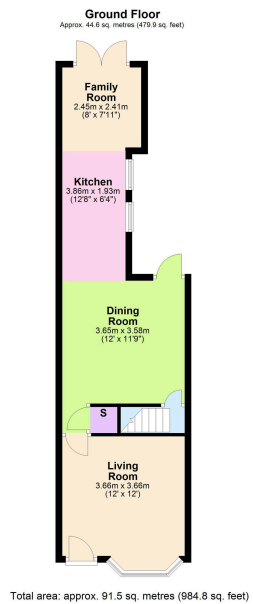

15-16 Market Place, Kettering,
Northamptonshire, NN16 0AJ

Disclaimer: These particulars do not form part of any offer or contract and should not be relied upon as statements or representations of fact. Any areas, measurements of distances are approximate. The text, photographs and plans are for guidance only and are not necessarily comprehensive.

