



Property Webb
At the HEART of your move

Primrose View, Armadale, EH48 2FQ

Offers Over £305,000

🛏️ 4 🚿 2 🚗 1



- Impressive detached 'Avondale' style Bellway home
- Presented in 'move in' condition
- Contemporary kitchen diner
- 2 ensuite
- South-west facing garden
- Popular commuter town of Armadale
- Generous living room
- Four bedrooms
- Stylish family bathroom
- Driveway and garage



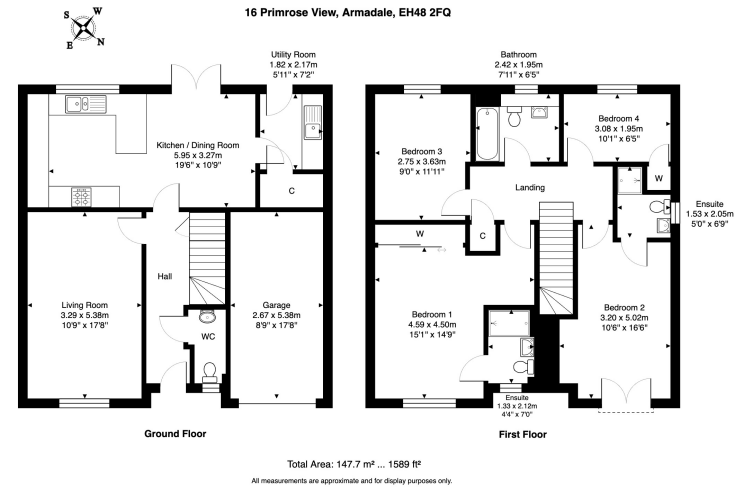

This beautiful 4 bedroom detached "Avondale" home by Bellway offers the perfect blend of style, space, and functionality in the sought-after commuter town of Armadale. With a bright and spacious living room, a contemporary kitchen diner opening to a sunny south-west facing garden, and the added convenience of a utility room and downstairs WC, it is designed for modern family living. Upstairs, four well appointed bedrooms, including two with ensuite bathrooms, are complemented by a sleek family bathroom, creating a layout that balances privacy and comfort. A double driveway and single garage complete this exceptional home, making it an ideal choice for families seeking a harmonious lifestyle in a desirable location.

01506 637553

info@property-webb.co.uk

www.property-webb.co.uk

71 South Bridge St, Bathgate, EH48 1TJ