

The Causeway, Congresbury

£465,000

3 1 2



Elizabethan, a detached two/three bedroomed bungalow perfectly positioned within the heart of Congresbury and offering a wonderful opportunity to now upgrade and extend, subject to the relevant planning. 1 The Causeway has been within a local family's ownership since new and has, over the years, been the subject of ongoing work both inside but also outside to the wraparound established gardens. These being a particular feature of this one off home which have been lovingly tended by the owners. A further area of garden to the rear is ripe for creating raised beds or for planting vegetables. We look forward to showing you around.



Key Features

- Detached two/three bedroomed bungalow
- Within walking distance to local shops, public houses and cafes
- Generous parking and detached garage
- No onward chain
- Wonderful opportunity extend and upgrade (subject to the relevant planning conditions)
- Double fronted property in the heart of this popular village
- Beautifully tended gardens to the side and an area of garden to the rear
- Gas central heating
- Council Tax band C
- EPC rating D

GROUND FLOOR
968 sq.ft. (89.9 sq.m.) approx.

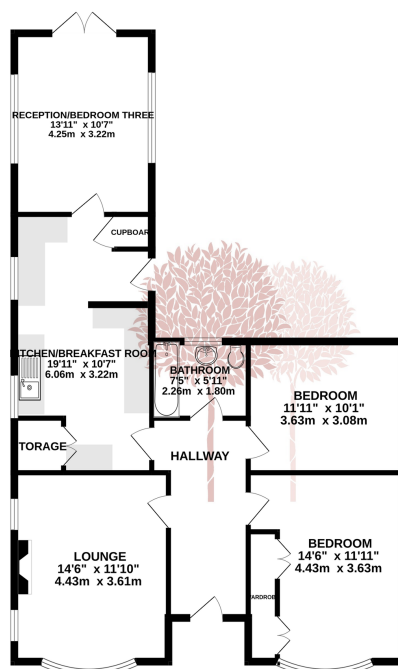

TOTAL FLOOR AREA: 968 sq.ft. (89.9 sq.m.) approx.

Whilst every attempt has been made to ensure the accuracy of the description contained here, measurements of doors, windows, rooms and any other items are approximate and no responsibility is taken for any error, omission or mis-statement. This plan is for illustrative purposes only and should be used as such by any prospective purchaser. The services, systems and appliances shown have not been tested and no guarantee is given as to their operability or efficiency at the time of writing.

Made with Metropac C2025

