



debbie fortune  
ESTATE AGENTS



## Badgworth Lane, Badgworth

£725,000

🛏️ 5 🚿 3 🛋️ 2

- Beautifully presented stone fronted home built in 2008
- Stunning front and rear gardens
- Five double bedrooms with an en-suite to the master bedroom
- Great access to the M5 and Bristol Airport
- Countryside views
- Situated in a peaceful village location
- Versatile accommodation arranged over three floors
- Picturesque walks on the doorstep
- EPC rating C
- New windows and doors fitted in 2024



**IMMACULATE CONDITION** - A beautifully presented detached family home combining the best of modern living with the charm of country life. Situated over three floors, the property benefits from versatile accommodation along with plenty of off street parking, well maintained gardens, and a large garage.

The property is set on a charming plot with a large, open frontage. The parking area, accessible via a private communal road, leads to a spacious shingle driveway that extends to a larger-than-average garage. The private rear garden is mainly laid to lawn with beautiful shrub borders and a patio area for dining in the summer months.

The whole house is in "just move in and unpack" condition, and would suit so many countryside lovers. Why not get out of the city and breathe some healthy air and watch deer run through fields.





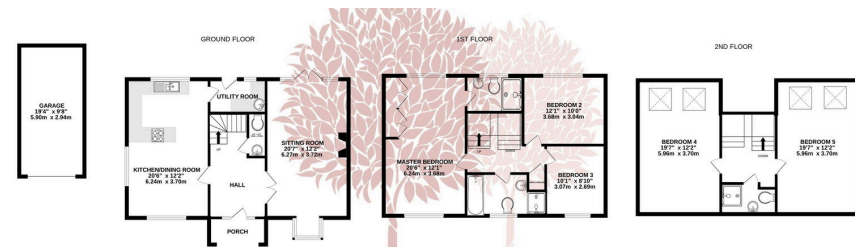

TOTAL FLOOR AREA: 1991sq. ft. (185.0 sq.m.) approx.  
 Whilst every attempt has been made to ensure the accuracy of the floorplan contained here, measurements of doors, windows, rooms and any other items are approximate and no responsibility is taken for any error, omission or mis-statement. The plan is for illustrative purposes only and should be used as such by any prospective purchaser. The services, systems and appliances shown have not been tested and no guarantee as to their operability or efficiency can be given.  
 Made with Metrepx 02021

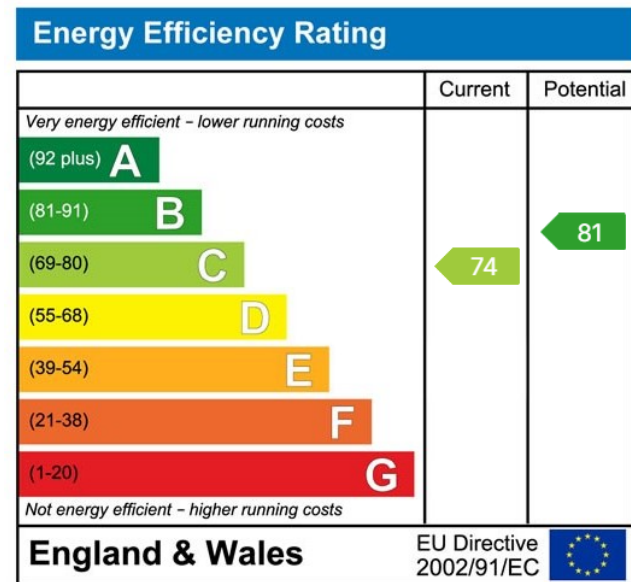

Bridge House, High Street, Congresbury BS49 5JA

[www.debbiefortune.co.uk](http://www.debbiefortune.co.uk)

