

Elm Close, Yatton

£395,000

🛏 2 🚿 1 🚗 1



A beautifully presented bungalow set within a generous corner plot, on an attractive residential road, perfectly positioned close enough to the centre of Yatton to take full advantage of the bustling village amenities, yet within a quiet backwater. Our owner having lovingly tended the level wraparound gardens to the highest standard over the years and having taken much joy from the different seasons. Once Inside, the bungalow offers two double bedrooms, bathroom and sitting room, with the kitchen flowing perfectly into the dining/family room to the rear. It's worth noting that, subject to the necessary planning consents, the garage could be converted into a double bedroom with ensuite.



Key Features

- Detached two bedroomed bungalow
- Beautifully presented throughout
- Well stocked beautiful level gardens to the side and rear
- Opportunity to convert the garage, with the necessary consent, to offer a third bedroom with ensuite shower room.
- Two double bedrooms with built in wardrobes
- Perfectly positioned in a quiet backwater of Yatton
- Open Plan kitchen, dining and family room opening through to gardens
- Parking for a number of cars
- Freehold Property
- EPC E

GROUND FLOOR
1206 sq.ft. (112.1 sq.m.) approx.

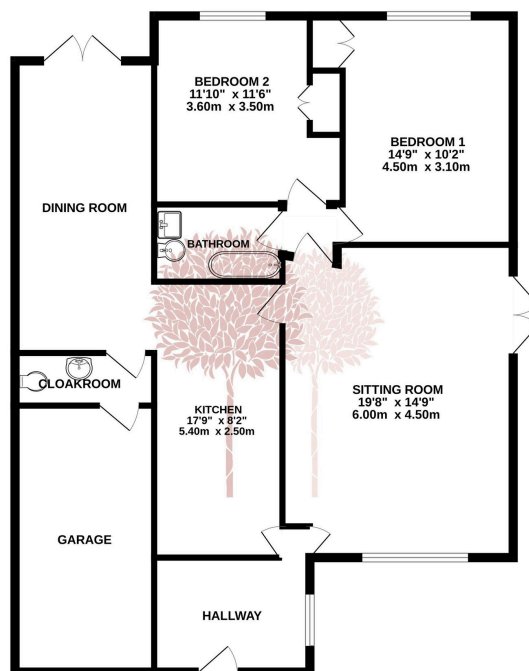

TOTAL FLOOR AREA: 1206 sq.ft. (112.1 sq.m.) approx.
While every attempt has been made to ensure the accuracy of the figures contained here, measurements of doors, windows, rooms and any other items are approximate and no responsibility is taken for any error, omission or mis-statement. This plan is for illustrative purposes only and should be used as such by any prospective purchaser. The services, systems and appliances shown have not been tested and no guarantee as to their operability or efficiency can be given.
Made with Metrepx ©2025

